



MS201 x 8



MS168 x 8

(1:1)

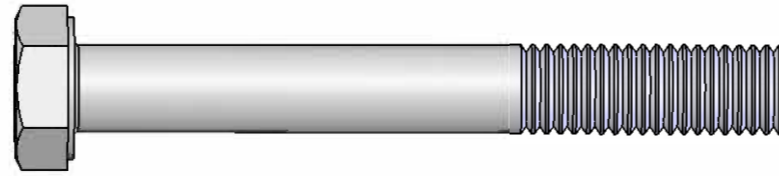

FB003 (M8 x 65) x 16

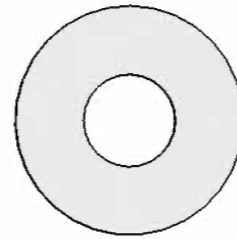

FW002 (M8) x 32



FN006 (M8) x 16

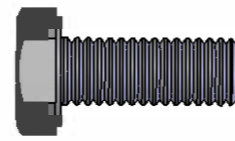

FS041 (M6 x 16) x 16

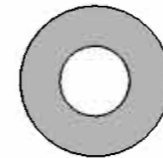

FW001 (M6) x 16



FW008 (M6) x 16

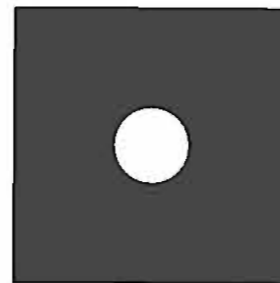

PS024 (M6) x 16

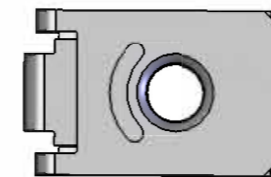

FN020 (M6) x 16

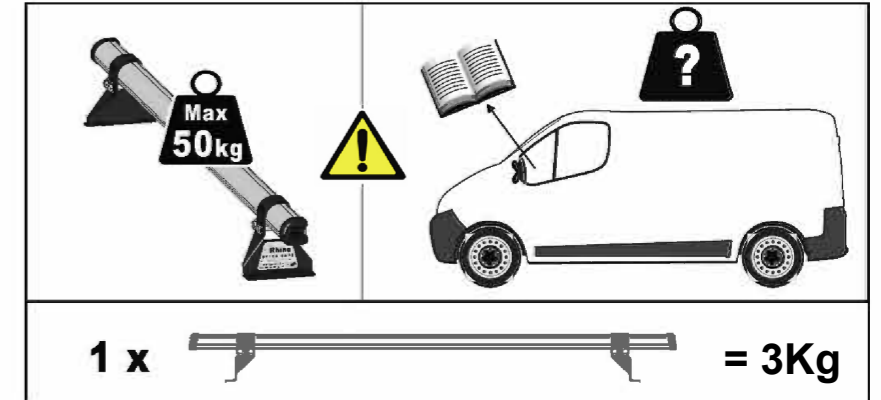

1 x [bar] = 3Kg

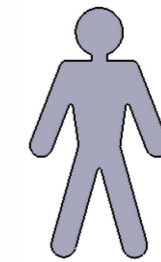

10mm x 1



13mm x 2

