

# Kit 1565

**FORD Focus**, 3-dr Hatchback, \*00-07

**FORD Focus**, 4-dr Sedan, \*00-07

**FORD Focus**, 5-dr Hatchback, \*02-07

**FORD Focus**, 5-dr Wagon, \*00-07

\*North America

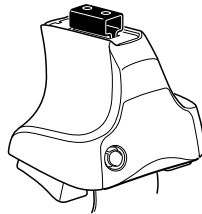

**754** Rapid System  
**480R** Rapid Traverse (North America)

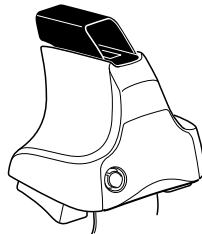
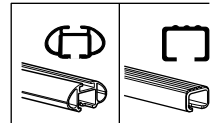

**480** Traverse (North America)

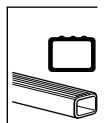

**Max. 60 kg**  
**Max. 132 lbs**

**754 Rapid System**  
**480R Rapid Traverse (North America)**

---

**754 Rapid System**  
**480R Rapid Traverse (North America)**

---

**480 Traverse (North America)**

**(North America)**

1

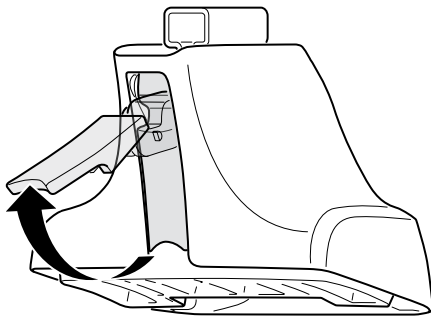

2



754 Rapid System  
480R Rapid Traverse  
(North America)

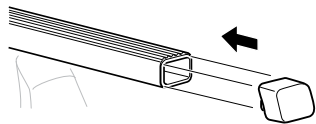
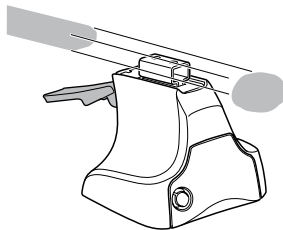

x4

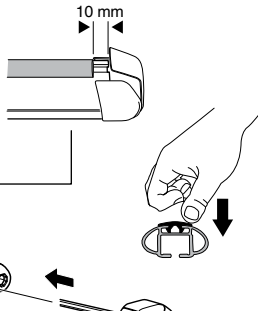
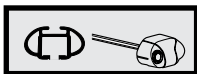

x4

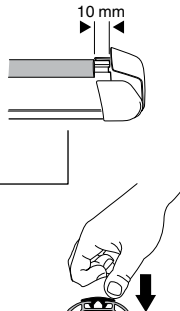
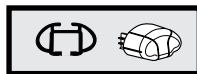

x4



480 Traverse  
(North America)

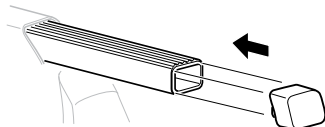
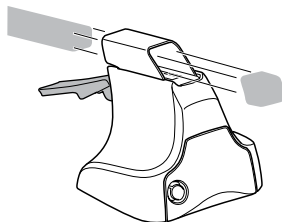

x4

**3**



**754** Rapid System

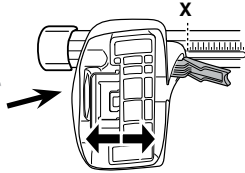

	X
<b>FORD Focus, 3-dr Hatchback, *00-07</b>	<b>33,5</b>
<b>FORD Focus, 4-dr Sedan, *00-07</b>	<b>32,5</b>
<b>FORD Focus, 5-dr Hatchback, *02-07</b>	<b>32,5</b>
<b>FORD Focus, 5-dr Wagon, *00-07</b>	<b>32</b>

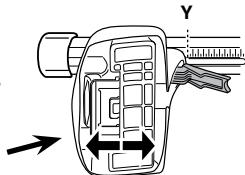

	Y
<b>FORD Focus, 3-dr Hatchback, *00-07</b>	<b>28</b>
<b>FORD Focus, 4-dr Sedan, *00-07</b>	<b>30</b>
<b>FORD Focus, 5-dr Hatchback, *02-07</b>	<b>29</b>
<b>FORD Focus, 5-dr Wagon, *00-07</b>	<b>28,5</b>

**3**



**480R** Rapid Traverse



**480** Traverse

**(North America)**

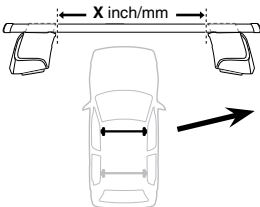

	X inch	X mm
<b>FORD Focus, 3-dr Hatchback, *00-07</b>	<b>38 <sup>7</sup>/<sub>8</sub> "</b>	<b>986 mm</b>
<b>FORD Focus, 4-dr Sedan, *00-07</b>	<b>38 <sup>3</sup>/<sub>8</sub> "</b>	<b>976 mm</b>
<b>FORD Focus, 5-dr Hatchback, *02-07</b>	<b>38 <sup>3</sup>/<sub>8</sub> "</b>	<b>976 mm</b>
<b>FORD Focus, 5-dr Wagon, *00-07</b>	<b>38 <sup>1</sup>/<sub>4</sub> "</b>	<b>971 mm</b>

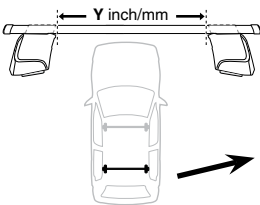

	Y inch	Y mm
<b>FORD Focus, 3-dr Hatchback, *00-07</b>	<b>36 <sup>5</sup>/<sub>8</sub> "</b>	<b>931 mm</b>
<b>FORD Focus, 4-dr Sedan, *00-07</b>	<b>37 <sup>1</sup>/<sub>2</sub> "</b>	<b>951 mm</b>
<b>FORD Focus, 5-dr Hatchback, *02-07</b>	<b>37 "</b>	<b>941 mm</b>
<b>FORD Focus, 5-dr Wagon, *00-07</b>	<b>36 <sup>7</sup>/<sub>8</sub> "</b>	<b>936 mm</b>

**4**

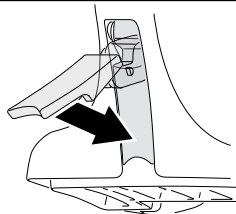

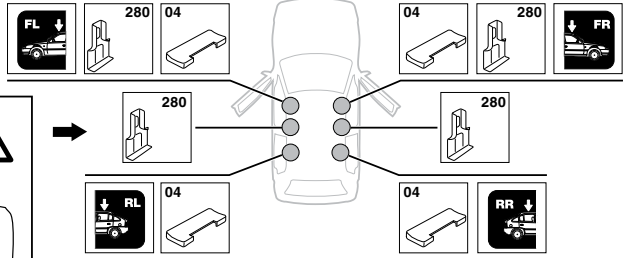
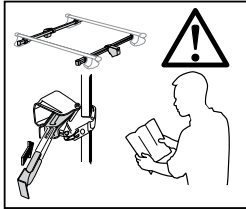
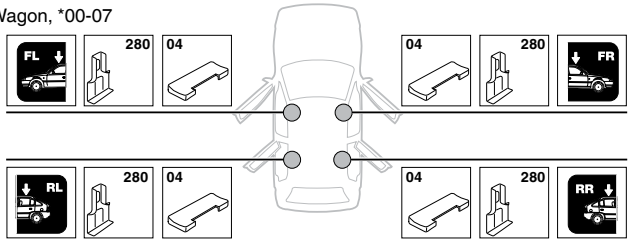
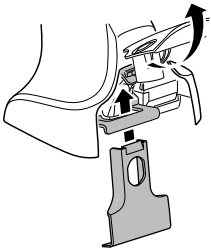
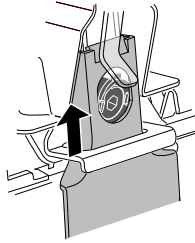
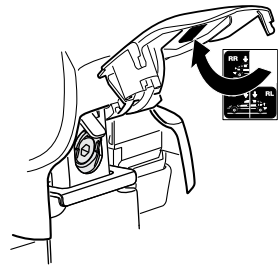
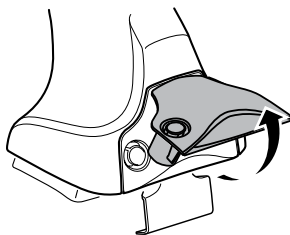
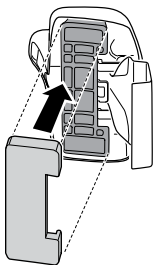
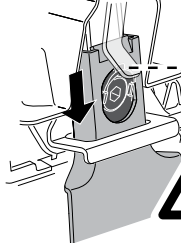
**5****FORD Focus, 3-dr Hatchback, \*00-07****SRA****FORD Focus, 4-dr Sedan, \*00-07****FORD Focus, 5-dr Hatchback, \*02-07****FORD Focus, 5-dr Wagon, \*00-07****A****B****C**

6

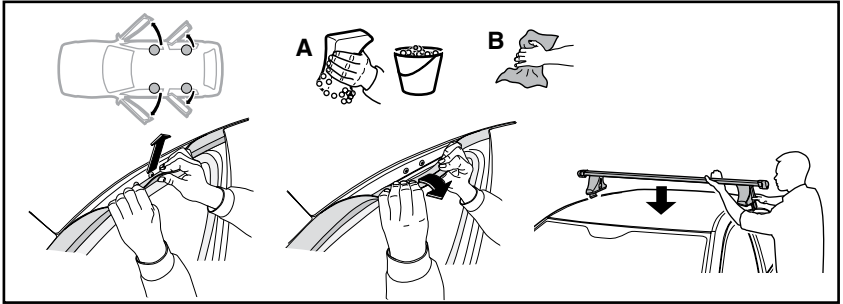

i

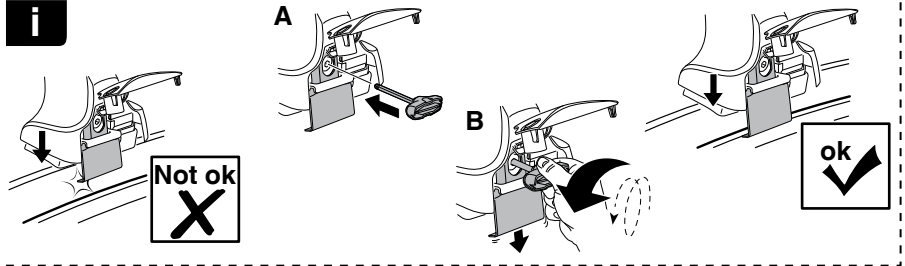

	X mm	Y mm	Z mm	X inch	Y inch	Z inch
<b>FORD Focus, 3-dr Hatchback, *00-07</b>	220 mm	700 mm	370 mm	8 5/8"	27 1/2"	14 5/8"

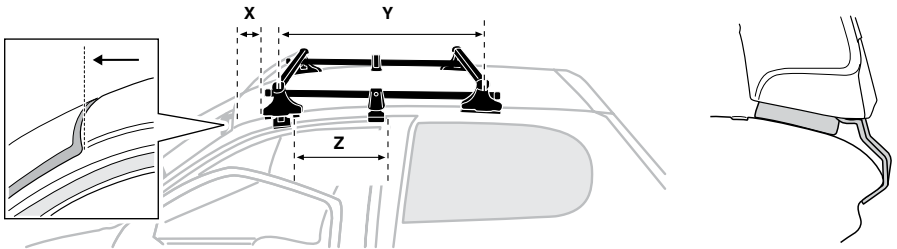

	X mm	Y mm	X inch	Y inch
<b>FORD Focus, 4-dr Sedan, *00-07</b>	220 mm	630 mm	8 5/8"	24 3/4"
<b>FORD Focus, 5-dr Hatchback, *02-07</b>	220 mm	630 mm	8 5/8"	24 3/4"
<b>FORD Focus, 5-dr Wagon, *00-07</b>	220 mm	630 mm	8 5/8"	24 3/4"

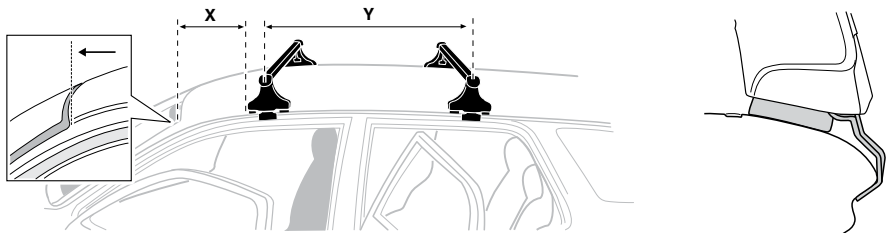

7



<b>GB/US</b>	Tighten alternately
<b>D</b>	Die Schrauben abwechselnd anziehen
<b>F</b>	Serrer alternativement chaque côté
<b>NL</b>	Afwisselend aan de linker- en de rechterkant aandraaien
<b>I</b>	Alternare il serraggio delle viti
<b>E</b>	Apertar alternativamente
<b>PT</b>	Aperte alternadamente
<b>S</b>	Dra åt växelvis
<b>FIN</b>	Kierrä vuorotellen
<b>EST</b>	Pinguldage vaheldumisi
<b>LAT</b>	Pielveiciet pamišus
<b>LIT</b>	Užsukinėkite pakaitomis
<b>PL</b>	Śruby dokręcaj naprzemiennie
<b>RU</b>	Загряивайте попеременно

<b>CZ</b>	Pokręřta багаžnika dokręcaj naprzemiennie.
<b>SK</b>	Dofahajte striedavo
<b>SLO</b>	Privijajte izmenično.
<b>HR</b>	Naizmjenično zategnite
<b>HU</b>	Egymástól függetlenül szorítandó
<b>GR</b>	Σφιγίγτες εναλλάξ
<b>TR</b>	Dönüşümlü sıkın

**中文** 交替拧紧

**한국어** 번갈아 가며 조이십시오.

**日本語** 交互に締め付けてください。

**ไทย** ชันในแบบสลับ

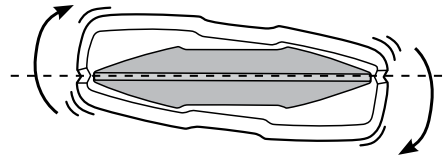
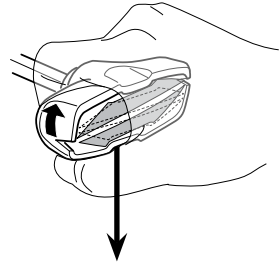
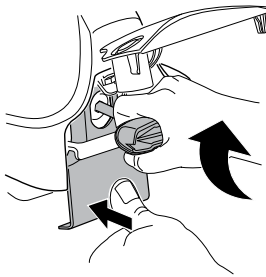
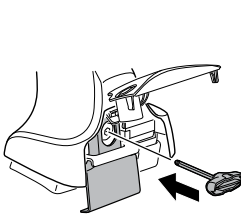

≈ 3 Nm

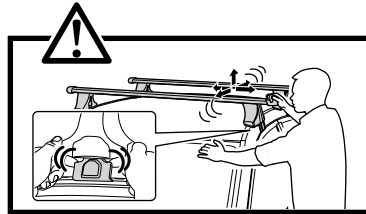
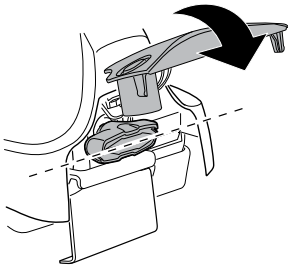

8



x1  
17 mm

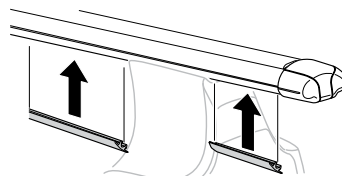
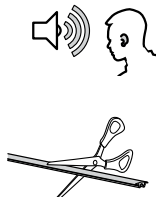

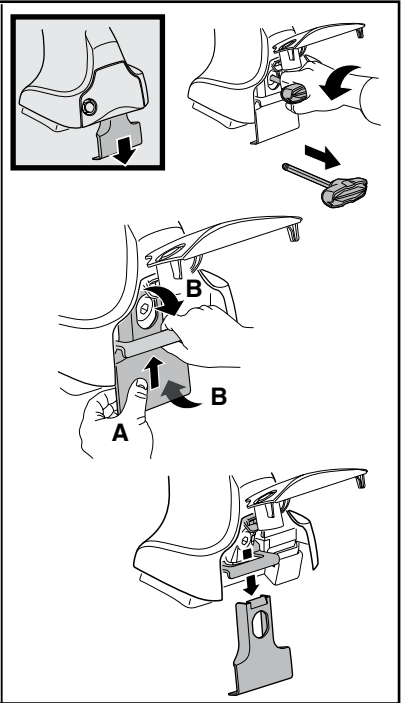
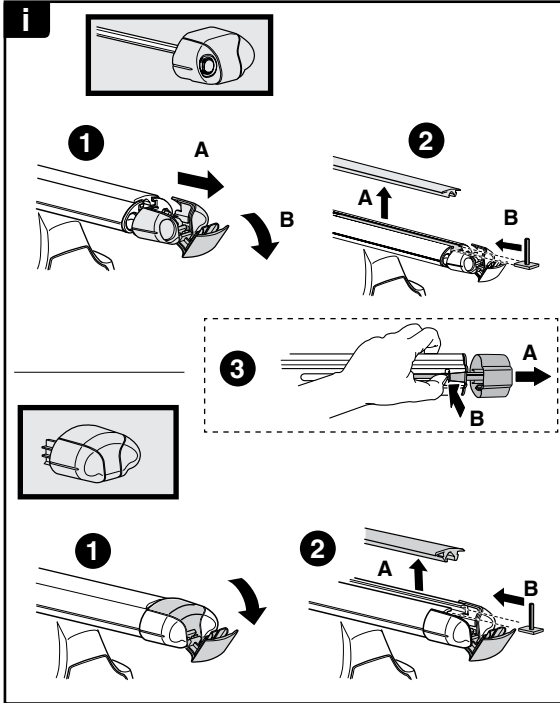

**THULE**  
SWEDEN  
**ONE  
KEY  
SYSTEM**



- 544 (x4)
  - 596 (x6)
  - 588 (x8)
  - 510 (x10)
  - 452 (x12)
- NA  
EUR  
ASIA



WW ▶ Thule Sweden AB, Box 69, 330 33 Hillerstorp, SWEDEN  
NA ▶ Thule Inc., 42 Silvermine Road, Seymour, Connecticut 06483, USA

info@thule.com  
customer.service@thule.com

www.thule.com