

Kit 1560

HONDA Accord, 4-dr Sedan, *08-

*North America

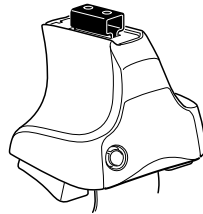

754 Rapid System
480R Rapid Traverse (North America)

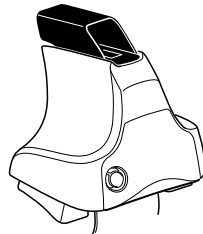
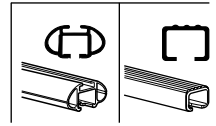

480 Traverse (North America)

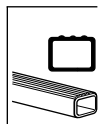

754 Rapid System
480R Rapid Traverse (North America)

480 Traverse (North America)

(North America)

679 x4 **06 x4**

RR **FR**
FL **RL**

x1

1

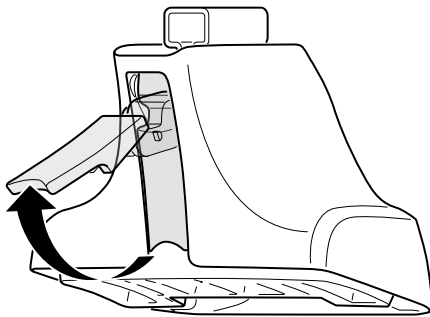

2

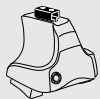

754 Rapid System
480R Rapid Traverse
(North America)

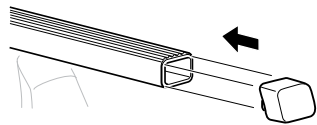
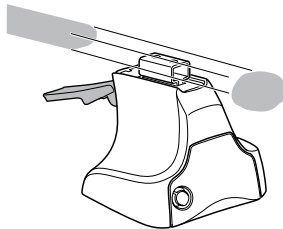

x4

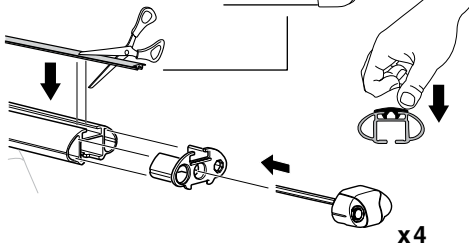
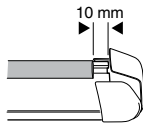
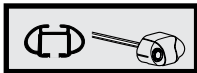

x4

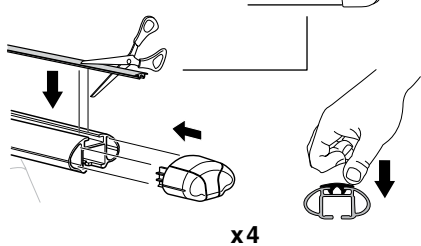
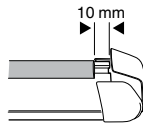
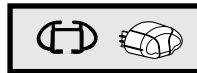

x4



480 Traverse
(North America)

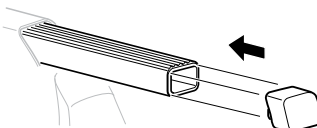
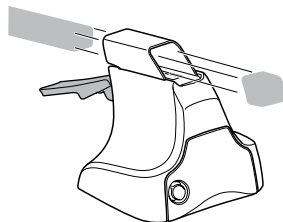

x4

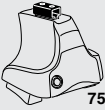
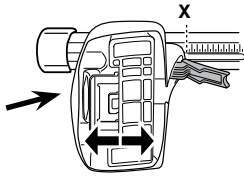
3**754** Rapid System

	X
HONDA Accord, 4-dr Sedan, *08-	42,5

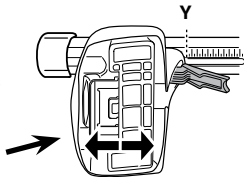

	Y
HONDA Accord, 4-dr Sedan, *08-	39

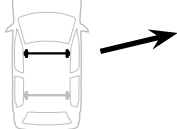
3**480R** Rapid Traverse**480** Traverse**(North America)**

	X inch	X mm
HONDA Accord, 4-dr Sedan, *08-	42 1/4"	1073 mm

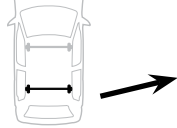

	Y inch	Y mm
HONDA Accord, 4-dr Sedan, *08-	41"	1040 mm

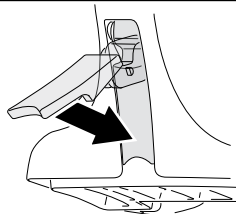
4

5

HONDA Accord, 4-dr Sedan, *08-

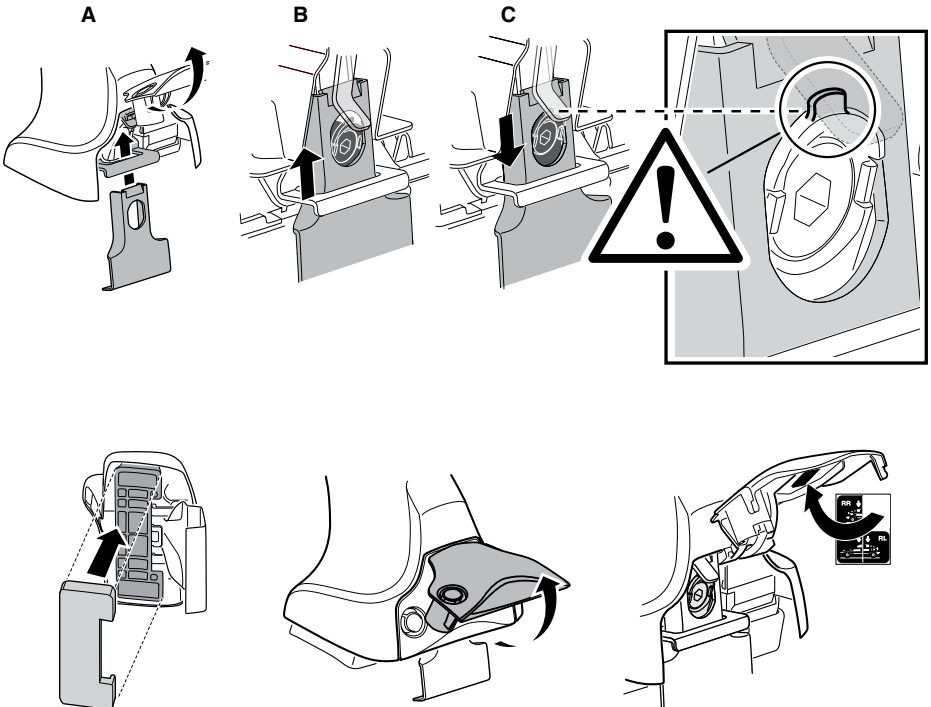
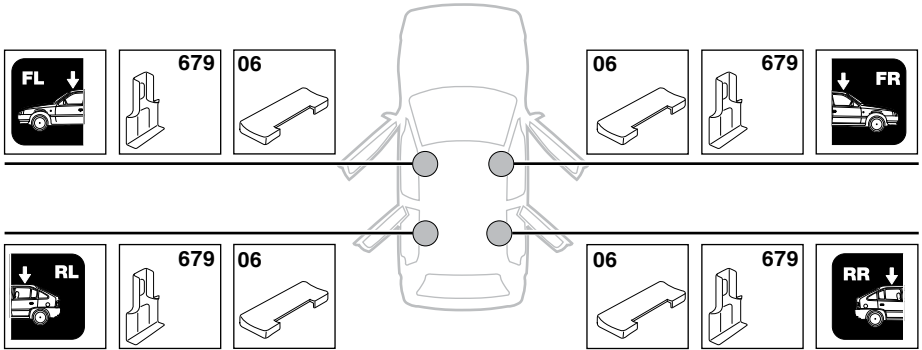

6

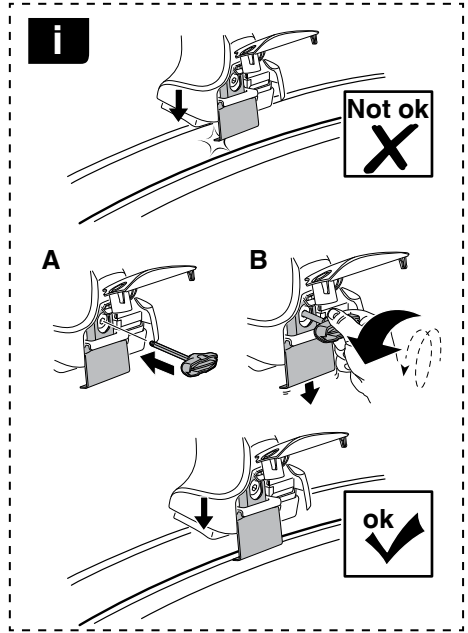

HONDA Accord, 4-dr Sedan, *08-

X mm	Y mm	X inch	Y inch
255 mm	700 mm	10"	27 1/2"

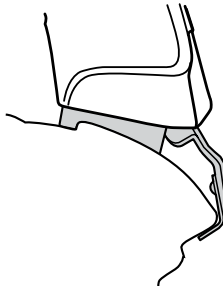
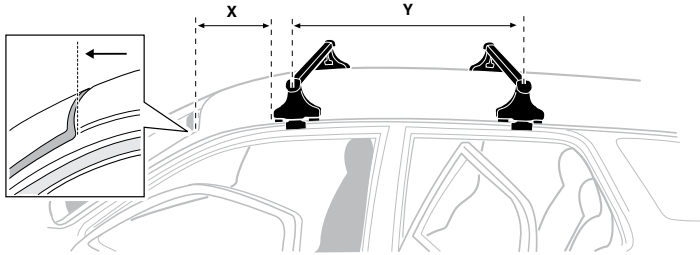

7

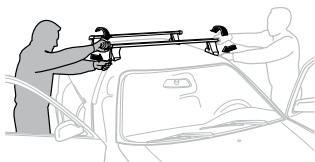

GB/US	Tighten alternately
D	Die Schrauben abwechselnd anziehen
F	Serrer alternativement chaque côté
NL	Afwisselend aan de linker- en de rechterkant aandraaien
I	Alternare il serraggio delle viti
E	Apertar alternativamente
PT	Aperte alternadamente
S	Dra åt växelvis
FIN	Kierrä vuorotellen
EST	Pinguldage vaheldumisi
LAT	Pielveiciet pamišus
LIT	Užsukinėkite pakaitomis
PL	Śruby dokręcaj naprzemiennie
RU	Загряивайте попеременно

CZ	Pokręřta багаžníka dokręřcaj dokręřcaj naprzemiennie.
SK	Dofahajte striedavo
SLO	Privijajte izmenično.
HR	Naizmjenično zategnite
HU	Egymástól függetlenül szorítandó
GR	Σφιγίγες ενολάξ
TR	Dönüşümlü sıkın

中文 交替拧紧

한국어 번갈아 가며 조이십시오.

日本語 交互に締め付けてください。

ไทย ชันในแบบสลับ

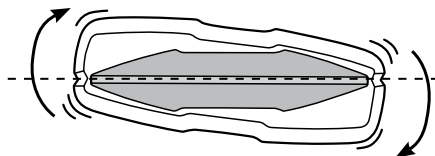
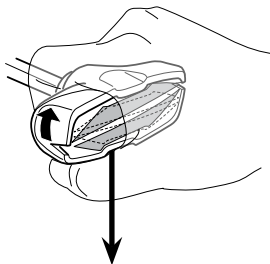
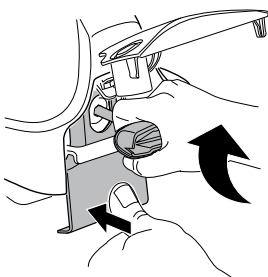
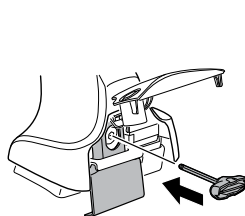

≈ 3 Nm

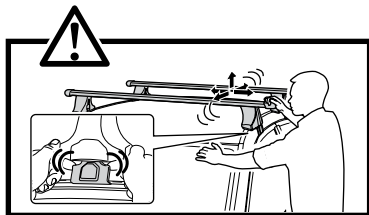
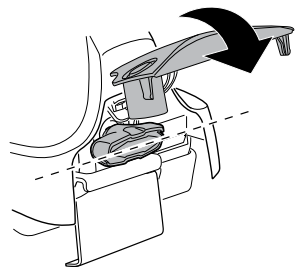

8

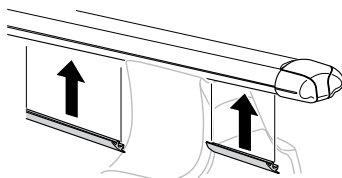
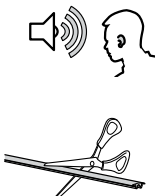
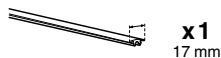

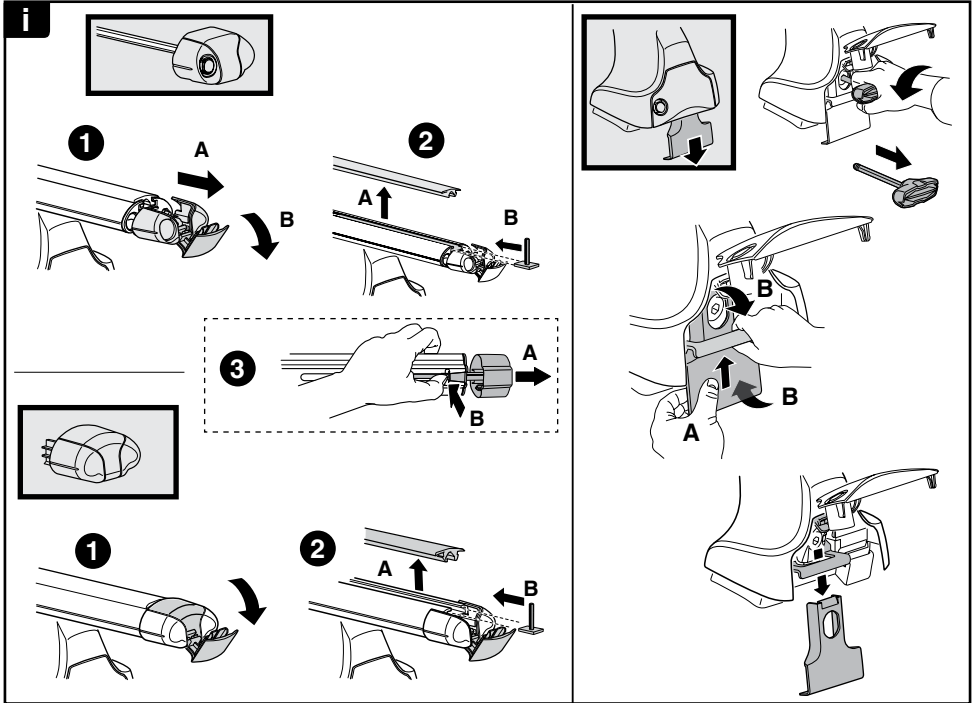

THULE
SWEDEN
**ONE
KEY
SYSTEM**

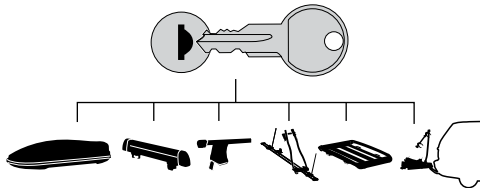

544 (x4)

596 (x6)

588 (x8)

NA **510** (x10)

EUR **452** (x12)

ASIA

