

# Kit 1418

TOYOTA Crown Comfort, 4-dr Sedan, 94-

480R  
754

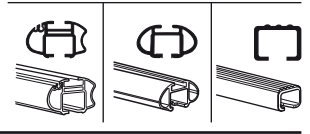

480

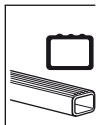

750

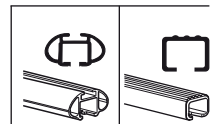
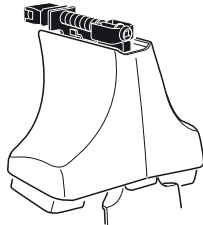

**THULE**<sup>®</sup>  
SWEDEN

ISO 11154-E

x2 x2 x2 x4	x2	x2 x2 x4 x4	x2 x2	x2

**797** x4

**163** x2

**164** x2

**x1**

**Kit**



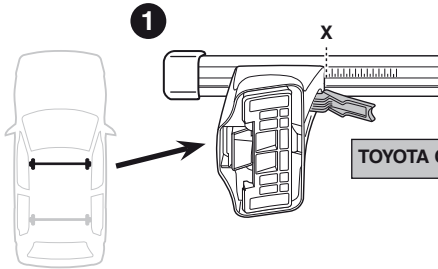

	X
TOYOTA Crown Comfort, 4-dr Sedan, 94-	37

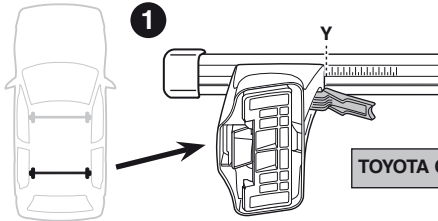

	Y
TOYOTA Crown Comfort, 4-dr Sedan, 94-	36

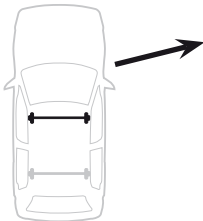

	X inch	X mm
TOYOTA Crown Comfort, 4-dr Sedan, 94-	40 1/4"	1021 mm

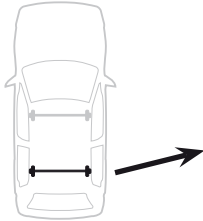

	Y inch	Y mm
TOYOTA Crown Comfort, 4-dr Sedan, 94-	39 3/4"	1011 mm



# 4

TOYOTA Crown Comfort, 4-dr Sedan, 94-

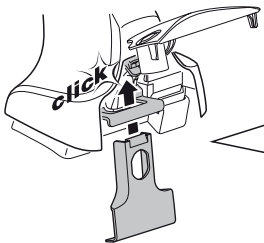
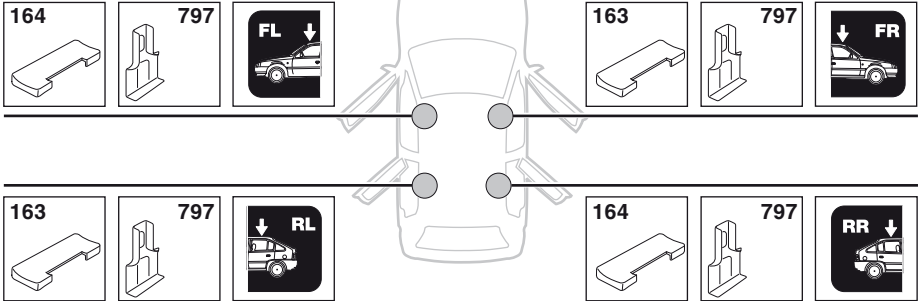

5



	X mm	Y mm	X inch	Y inch
TOYOTA Crown Comfort, 4-dr Sedan, 94-	220 mm	900 mm	8 <sup>5</sup> / <sub>8</sub> "	35 <sup>3</sup> / <sub>8</sub> "

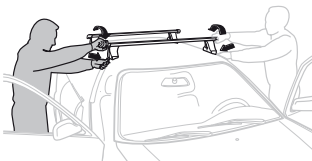
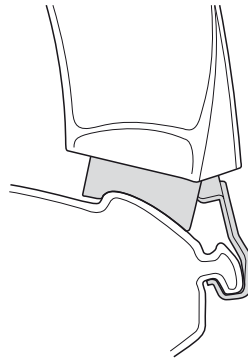
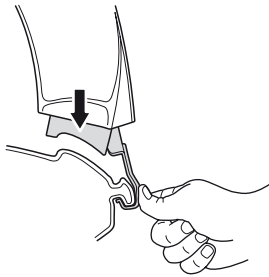
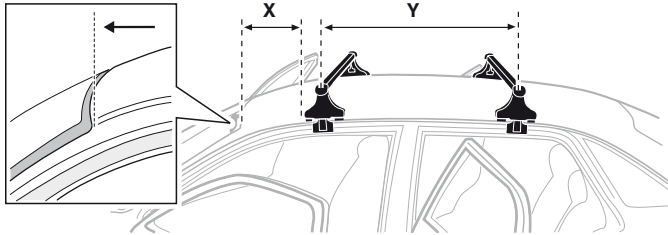

- GB/US** Tighten alternately
- D** Die Schrauben abwechselnd anziehen
- F** Serrer alternativement chaque côté
- NL** Afwisselend aan de linker- en de rechterkant aandraaien
- I** Alternare il serraggio delle viti
- E** Apretar alternativamente
- PT** Aperte alternadamente
- S** Dra åt växelvis
- FIN** Kierrä vuorotellen
- EST** Pinguldage vaheldumisi
- LAT** Pievelciēt pamišus
- LIT** Užsukinėkite pakaitomis
- PL** Śruby dokręcaj naprzemiennie
- RU** Затягивайте попеременно

- CZ** Pokręťta bagażnika dokręcaj dokręcaj naprzemiennie.
- SK** Dotahujte striedavo
- SLO** Privijajte izmenično.
- HR** Naizmjениčno zategnite
- HU** Egymástól függetlenül szorítandó
- GR** Σφιγίγτε εναλλάξ
- TR** Dönüşümlü sıkın

**中文** 交替拧紧

**한국어** 번갈아 가며 조이십시오.

**日本語** 交互に締め付けてください。

**ไทย** ชับในแบบสลับ

6



480R/754



480

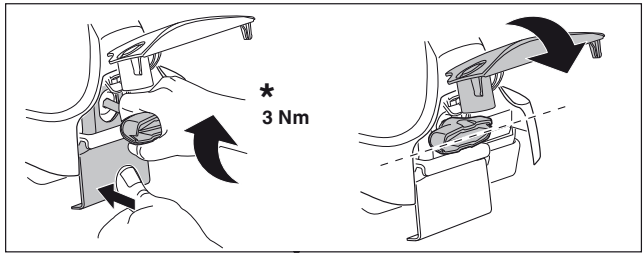
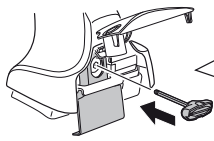

\*  
3 Nm



\*

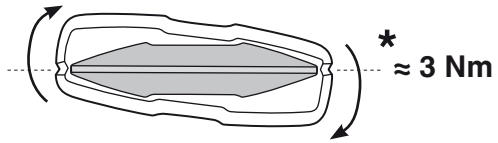

\*  
≈ 3 Nm

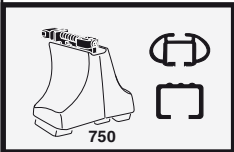
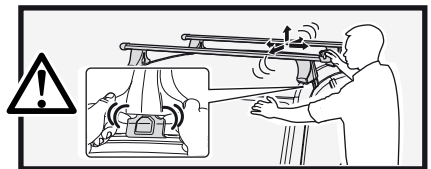

750

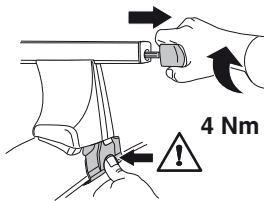

4 Nm

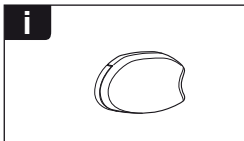
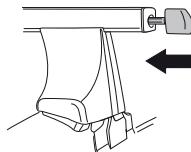

i

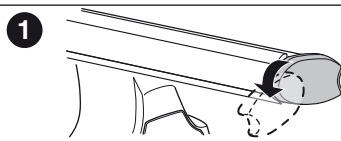

1

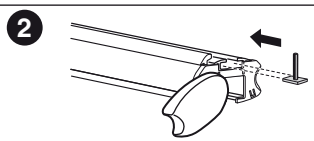

2

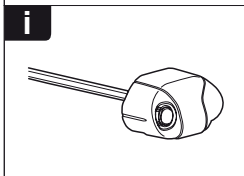

i

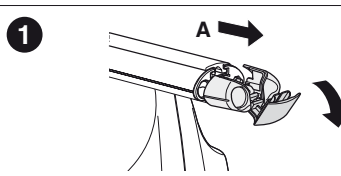

1

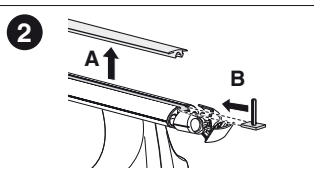

2

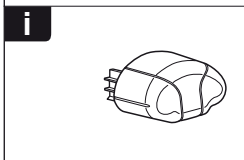

i

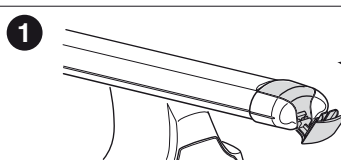

1

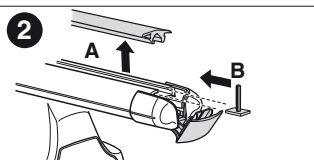

2

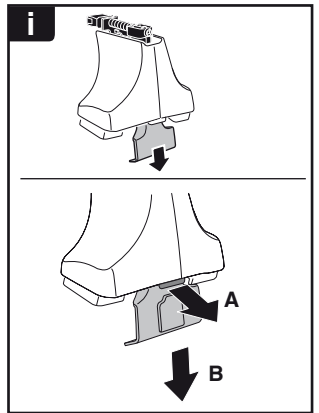

**THULE**  
SWEDEN  
**ONE  
KEY  
SYSTEM**



- 544 (x4)
- 596 (x6)
- 588 (x8)
- NA 510 (x10)
- EUR 452 (x12)
- ASIA



WW ▶ Thule Sweden AB, Box 69, 330 33 Hillerstorp, SWEDEN  
NA ▶ Thule Inc., 42 Silvermine Road, Seymour, Connecticut 06483, USA

info@thule.com  
customer.service@thule.com

www.thule.com