

Kit 1310

TOYOTA Kluger V, 5-dr SUV, 00-06

TOYOTA Highlander, 5-dr SUV, 00-06

480R
754

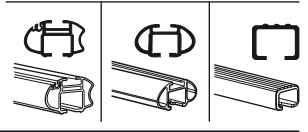
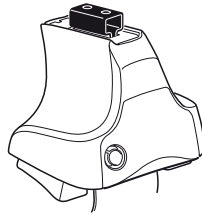

480

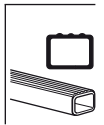
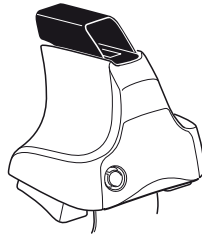

750

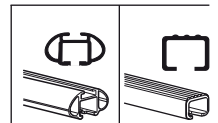
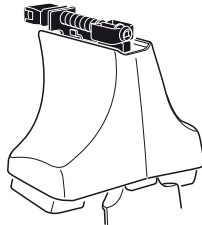

Kit



3

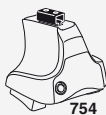

754

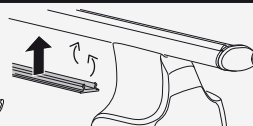
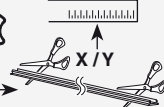

750



1

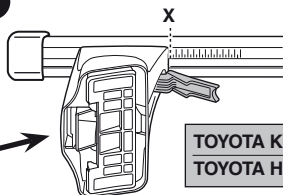
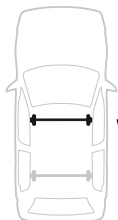

2



	X
TOYOTA Kluger V, 5-dr SUV, 00-06	44,5
TOYOTA Highlander, 5-dr SUV, 00-06	44,5

1

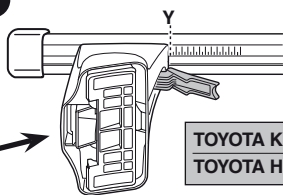

2

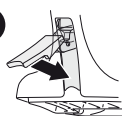

	Y
TOYOTA Kluger V, 5-dr SUV, 00-06	42
TOYOTA Highlander, 5-dr SUV, 00-06	42



480R



480

1

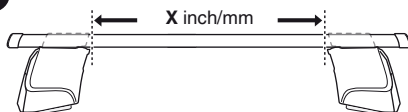

2



	X inch	X mm
TOYOTA Kluger V, 5-dr SUV, 00-06	43 1/8"	1096 mm
TOYOTA Highlander, 5-dr SUV, 00-06	43 1/8"	1096 mm

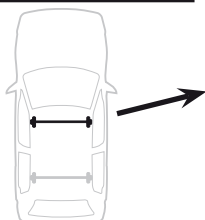

1

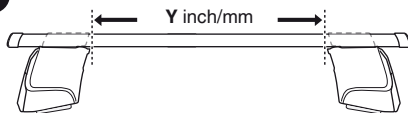

2

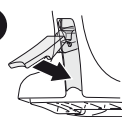

	Y inch	Y mm
TOYOTA Kluger V, 5-dr SUV, 00-06	42 1/8"	1071 mm
TOYOTA Highlander, 5-dr SUV, 00-06	42 1/8"	1071 mm

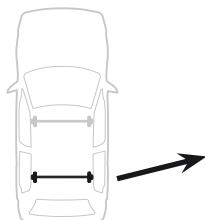

4

TOYOTA Kluger V, 5-dr SUV, 00-06
 TOYOTA Highlander, 5-dr SUV, 00-06

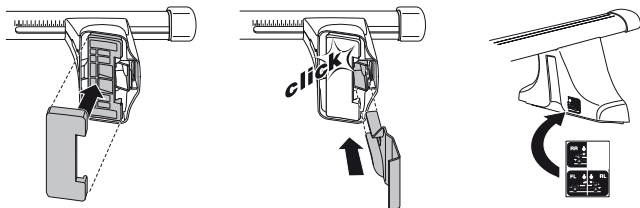
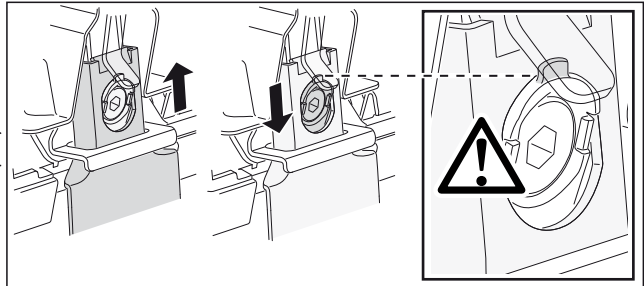
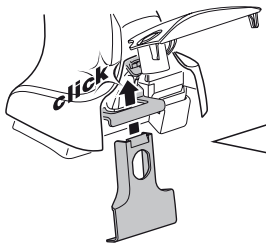
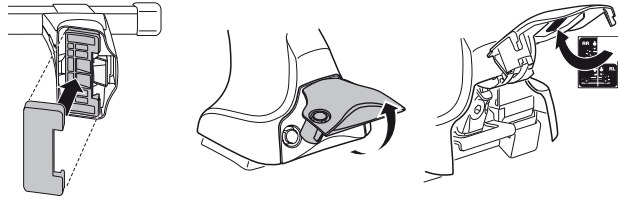
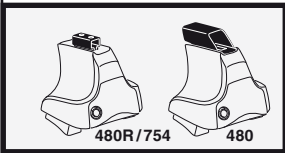
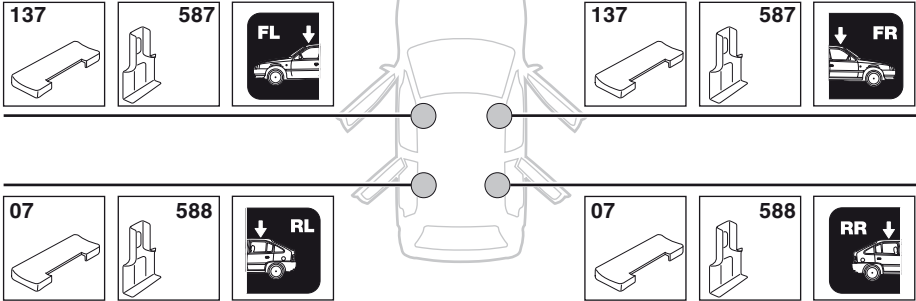

5



	X mm	Y mm	X inch	Y inch
TOYOTA Kluger V, 5-dr SUV, 00-06	460 mm	710 mm	18 1/8"	28"
TOYOTA Highlander, 5-dr SUV, 00-06	460 mm	710 mm	18 1/8"	28"

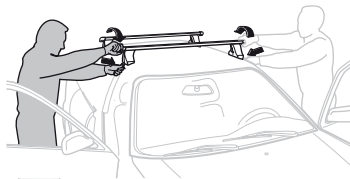
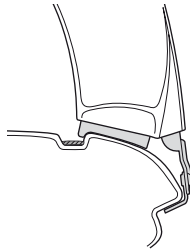
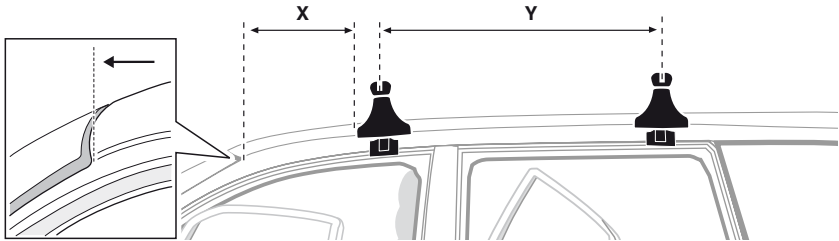

GB/US Tighten alternately

D Die Schrauben abwechselnd anziehen

F Serrer alternativement chaque côté

NL Afwisselend aan de linker- en de rechterkant aandraaien

I Alternare il serraggio delle viti

E Apretar alternativamente

PT Aperte alternadamente

S Dra åt växelvis

FIN Kierrä vuorotellen

EST Pinguldage vaheldumisi

LAT Pielvelciet pamišus

LIT Užsukinėkite pakaitomis

PL Śruby dokręcaj naprzemiennie

RU Затягивайте попеременно

CZ Pokręťta bagażníka dokręcaj dokręcaj naprzemiennie.

SK Doťahujte striedavo

SLO Privijajte izmenično.

HR Naizmjenično zategnite

HU Egymástól függetlenül szorítandó

GR Σφίγγετε εναλλάξ

TR Dönüşümlü sıkın

中文 交替拧紧

한국어 번갈아 가며 조이십시오.

日本語 交互に締め付けてください。

ไทย ชั้้นโน้แบบสลับ

6



480R/754



480

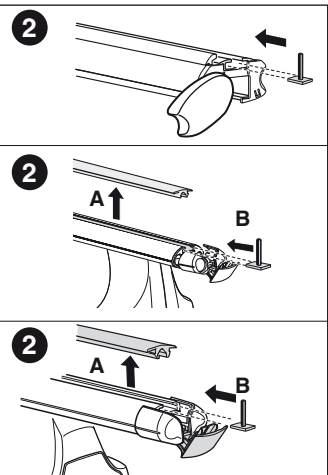
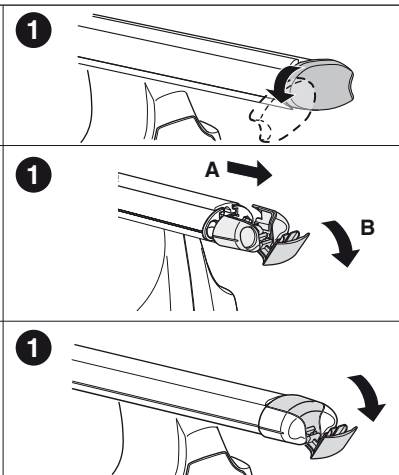
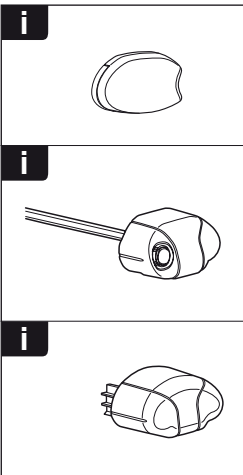
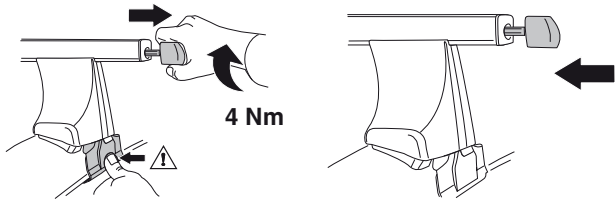
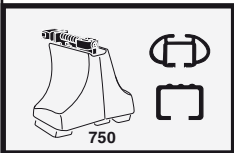
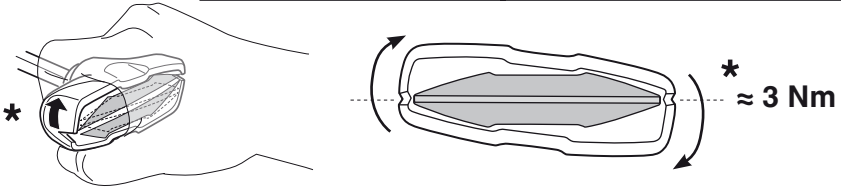
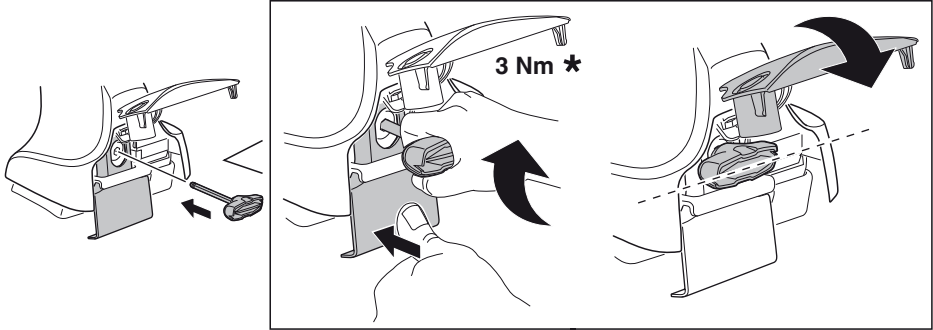

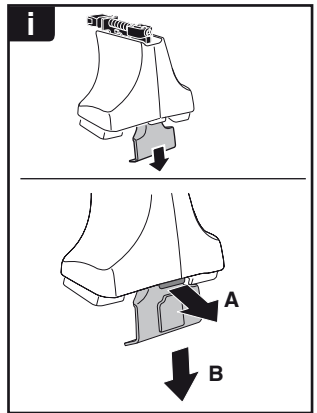
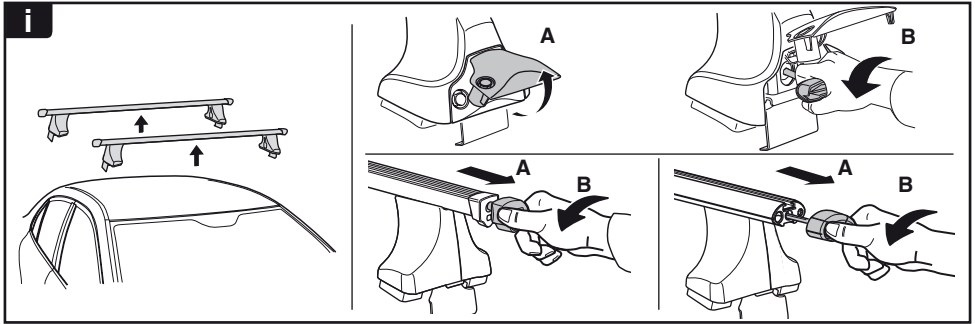

THULE
SWEDEN
**ONE
KEY
SYSTEM**



- 544 (x4)
- 596 (x6)
- 588 (x8)
- NA 510 (x10)
- EUR 452 (x12)
- ASIA 452 (x12)



WW ▶ Thule Sweden AB, Box 69, 330 33 Hillerstorp, SWEDEN
NA ▶ Thule Inc., 42 Silvermine Road, Seymour, Connecticut 06483, USA

info@thule.com
customer.service@thule.com

www.thule.com