

# Kit 1255

HYUNDAI Lavita, 5-dr MPV, 01-

HYUNDAI Matrix, 5-dr MPV, 01-

HYUNDAI FC, 5-dr MPV, 01-

480R  
754

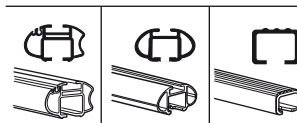
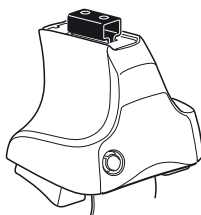

480

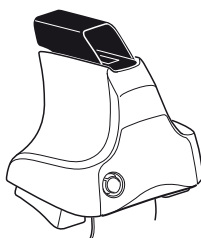

750

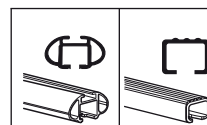
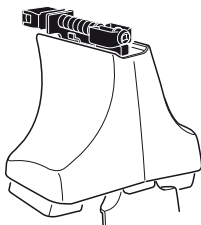

**THULE**<sup>®</sup>  
SWEDEN

**Kit**



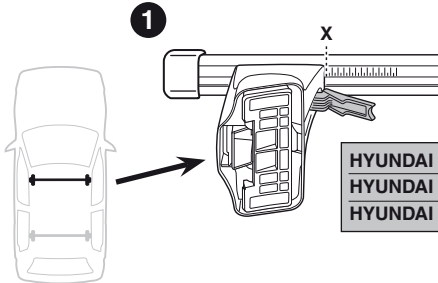

	X
HYUNDAI Lavita, 5-dr MPV, 01-	37,5
HYUNDAI Matrix, 5-dr MPV, 01-	37,5
HYUNDAI FC, 5-dr MPV, 01-	37,5

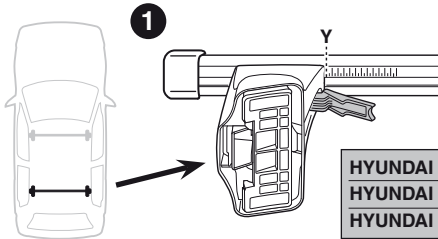

	Y
HYUNDAI Lavita, 5-dr MPV, 01-	36
HYUNDAI Matrix, 5-dr MPV, 01-	36
HYUNDAI FC, 5-dr MPV, 01-	36

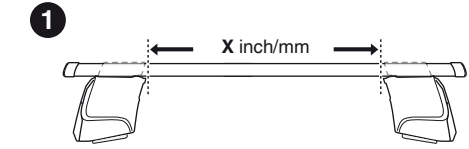
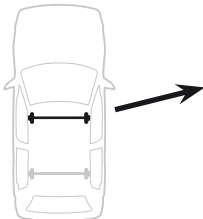

	X inch	X mm
HYUNDAI Lavita, 5-dr MPV, 01-	40 <sup>3</sup> / <sub>8</sub> "	1026 mm
HYUNDAI Matrix, 5-dr MPV, 01-	40 <sup>3</sup> / <sub>8</sub> "	1026 mm
HYUNDAI FC, 5-dr MPV, 01-	40 <sup>3</sup> / <sub>8</sub> "	1026 mm

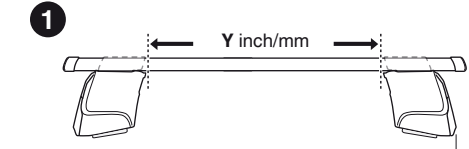
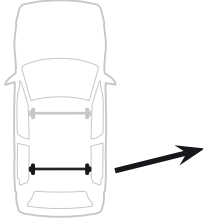

	Y inch	Y mm
HYUNDAI Lavita, 5-dr MPV, 01-	39 <sup>3</sup> / <sub>4</sub> "	1011 mm
HYUNDAI Matrix, 5-dr MPV, 01-	39 <sup>3</sup> / <sub>4</sub> "	1011 mm
HYUNDAI FC, 5-dr MPV, 01-	39 <sup>3</sup> / <sub>4</sub> "	1011 mm



# 4

HYUNDAI Lavita, 5-dr MPV, 01-  
 HYUNDAI Matrix, 5-dr MPV, 01-  
 HYUNDAI FC, 5-dr MPV, 01-

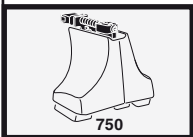
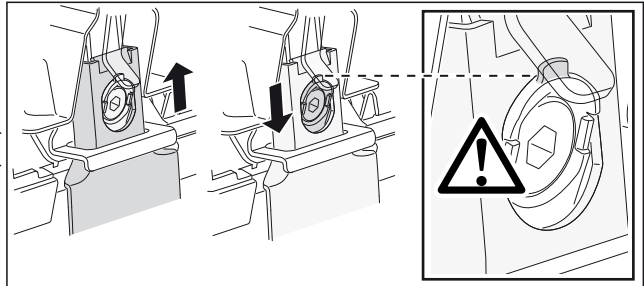
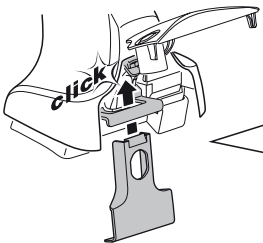
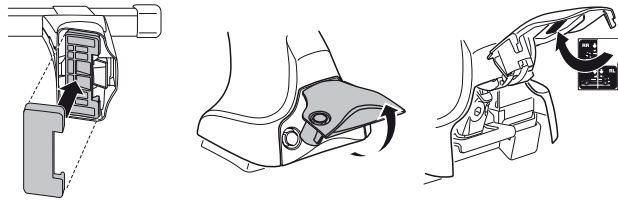
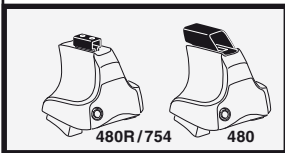
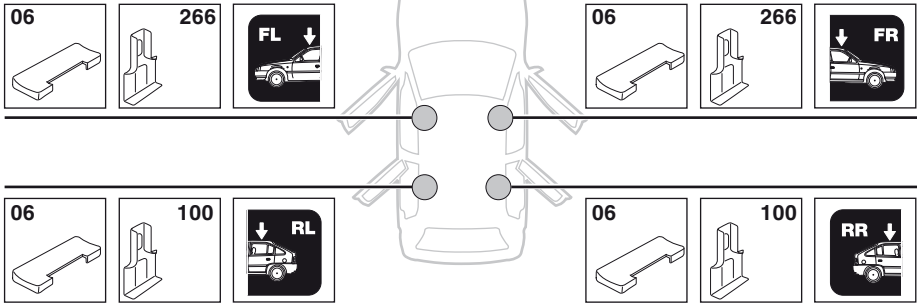

5



	X mm	Y mm	X inch	Y inch
<b>HYUNDAI Lavita</b> , 5-dr MPV, 01-	410 mm	700 mm	16 1/8"	27 1/2"
<b>HYUNDAI Matrix</b> , 5-dr MPV, 01-	410 mm	700 mm	16 1/8"	27 1/2"
<b>HYUNDAI FC</b> , 5-dr MPV, 01-	410 mm	700 mm	16 1/8"	27 1/2"

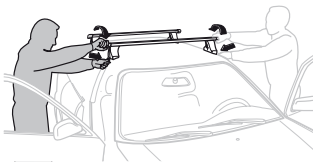
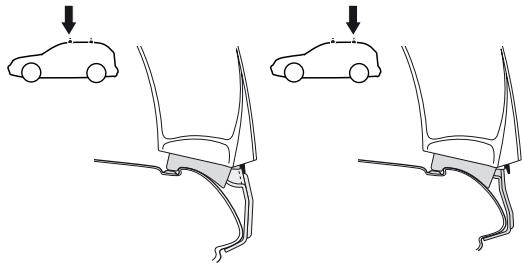
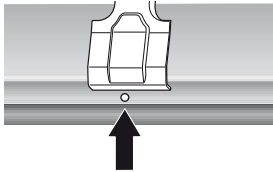
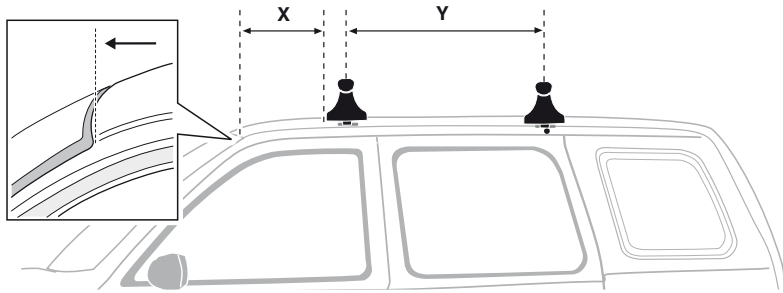

**GB/US** Tighten alternately  
**D** Die Schrauben abwechselnd anziehen  
**F** Serrer alternativement chaque côté  
**NL** Afwisselend aan de linker- en de rechterkant aandraaien  
**I** Alternare il serraggio delle viti  
**E** Apretar alternativamente  
**PT** Aperte alternadamente  
**S** Dra åt växelvis  
**FIN** Kierrä vuorotellen  
**EST** Pinguldage vaheldumisi  
**LAT** Pievelciēt pamīšus  
**LIT** Užsukinėkite pakaitomis  
**PL** Śruby dokręcaj naprzemiennie  
**RU** Затягивайте попеременно

**CZ** Pokręťta багаžníka dokręcaj naprzemiennie.  
**SK** Doťahujte striedavo  
**SLO** Privijajte izmenično.  
**HR** Naizmjenočno zategnite  
**HU** Egy mástól függetlenül szorítandó  
**GR** Σφιγγετε εναλλάξ  
**TR** Dönüşümlü sıkın

**中文** 交替拧紧  
**한국어** 번갈아 가며 조이십시오.  
**日本語** 交互に締め付けてください。  
**ไทย** ชั้้นในแบบสลับ

6



480R/754



480

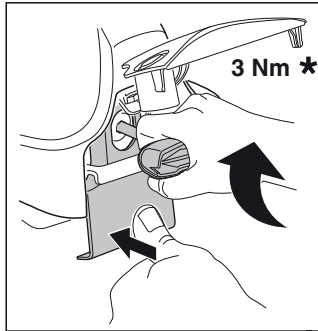

3 Nm \*

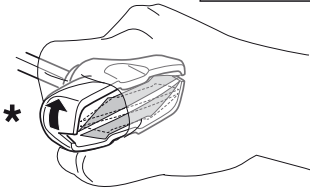
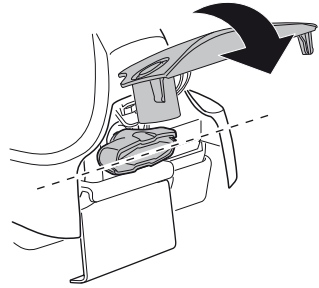

\*

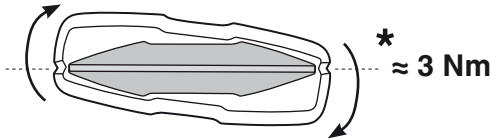

\* ≈ 3 Nm



750

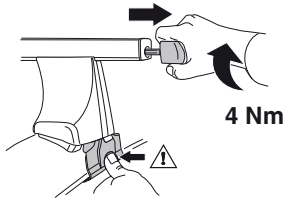



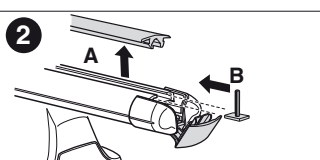
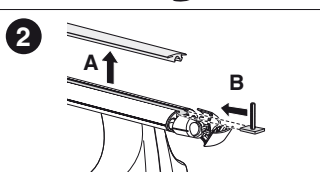
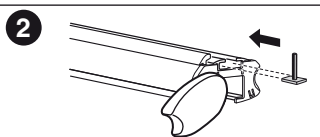
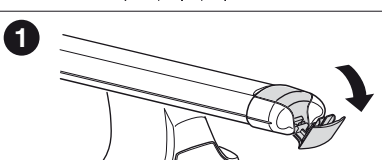
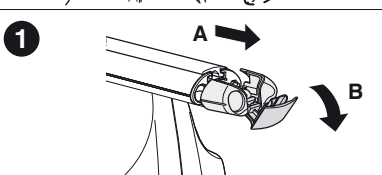
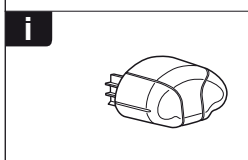
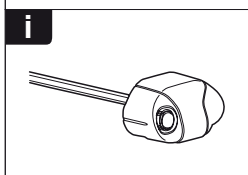
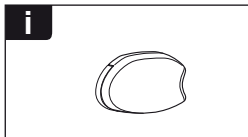
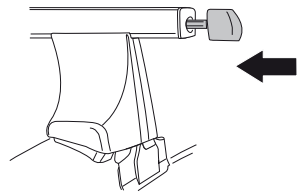

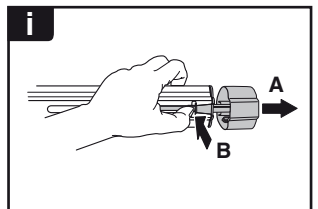
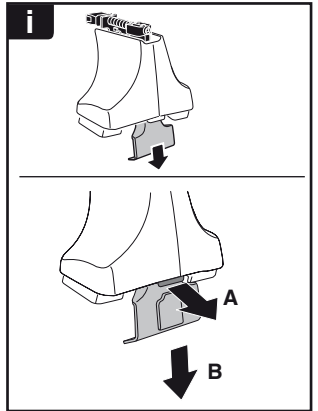
4 Nm





**THULE**  
SWEDEN  
**ONE  
KEY  
SYSTEM**



-  **544** (x4)
  -  **596** (x6)
  -  **588** (x8)
  -  **510** (x10)
  -  **452** (x12)
- NA  
EUR  
ASIA



WW ▶ Thule Sweden AB, Box 69, 330 33 Hillerstorp, SWEDEN  
NA ▶ Thule Inc., 42 Silvermine Road, Seymour, Connecticut 06483, USA

info@thule.com  
customer.service@thule.com

 www.thule.com