

Kit 1230

LEXUS IS 200/300 Sportcross, 5-dr Estate, 99-04
TOYOTA Altezza, 5-dr Estate, 98-04

480R
754

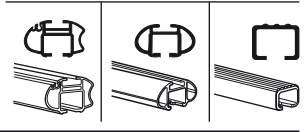
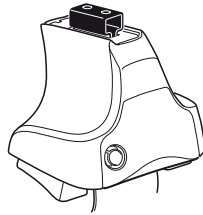

480

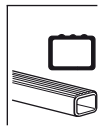
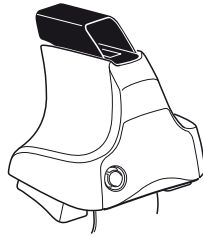

750

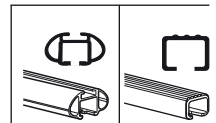
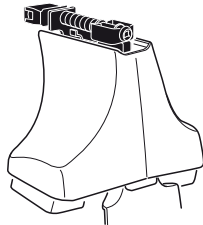

Kit



3

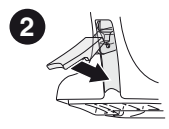
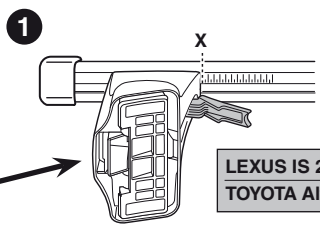
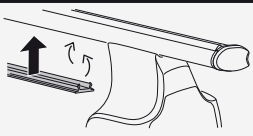
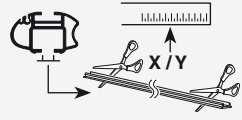
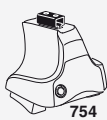

	X
LEXUS IS 200/300 Sportcross, 5-dr Estate, 99-04	33
TOYOTA Altezza, 5-dr Estate, 98-04	33

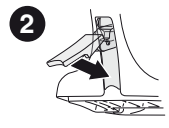
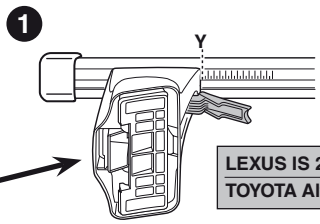
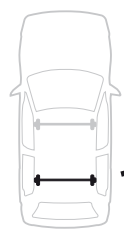

	Y
LEXUS IS 200/300 Sportcross, 5-dr Estate, 99-04	31
TOYOTA Altezza, 5-dr Estate, 98-04	31



480R



480

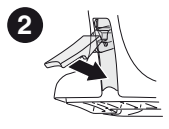
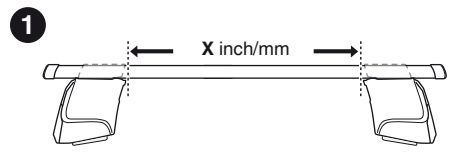
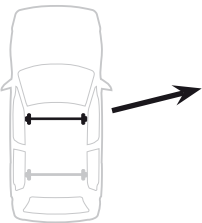

	X inch	X mm
LEXUS IS 200/300 Sportcross, 5-dr Estate, 99-04	38 5/8"	981 mm
TOYOTA Altezza, 5-dr Estate, 98-04	38 5/8"	981 mm

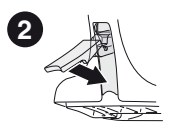
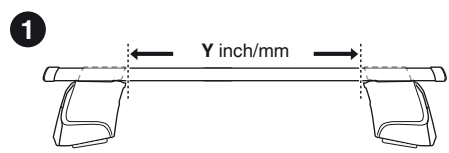
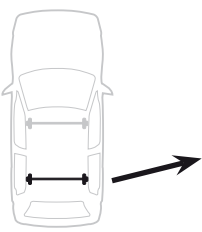

	Y inch	Y mm
LEXUS IS 200/300 Sportcross, 5-dr Estate, 99-04	37 7/8"	961 mm
TOYOTA Altezza, 5-dr Estate, 98-04	37 7/8"	961 mm

4

LEXUS IS 200/300 Sportcross, 5-dr Estate, 99-04
 TOYOTA Altezza, 5-dr Estate, 98-04

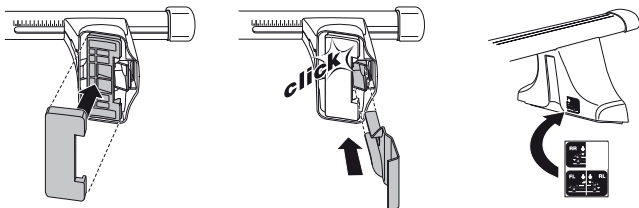
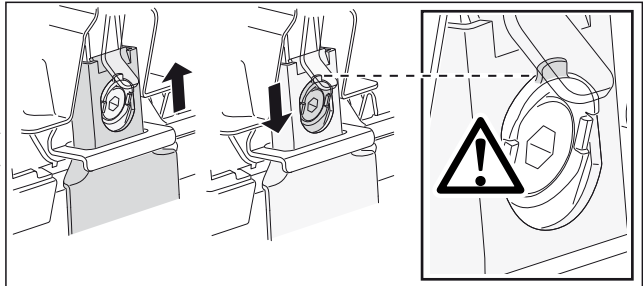
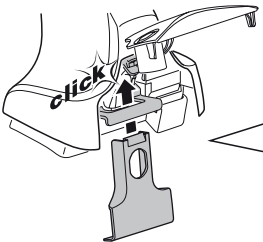
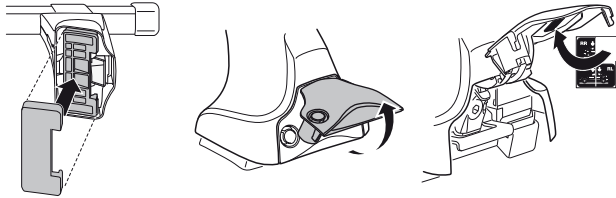
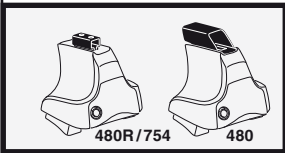
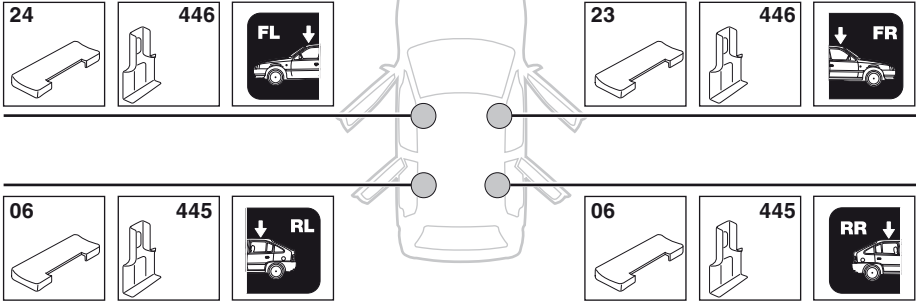

5



	X mm	Y mm	X inch	Y inch
LEXUS IS 200/300 Sportcross, 5-dr Estate, 99-04	180 mm	700 mm	7 1/8"	27 1/2"
TOYOTA Altezza, 5-dr Estate, 98-04	180 mm	700 mm	7 1/8"	27 1/2"

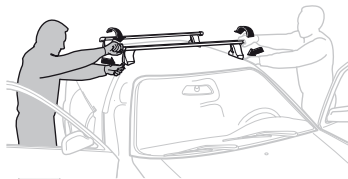
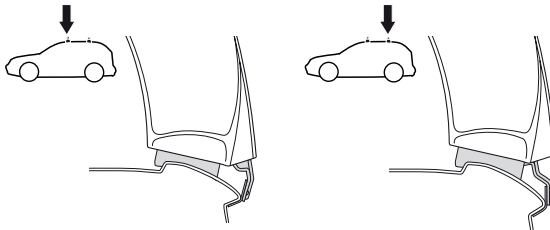
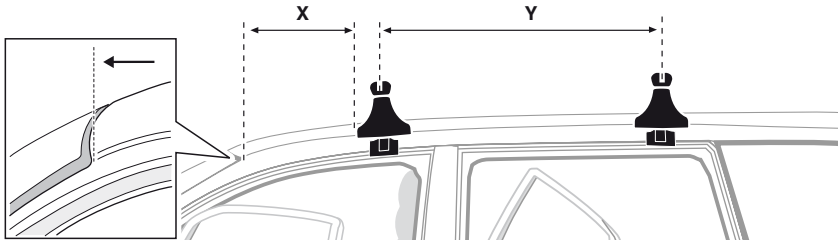

GB/US Tighten alternately

D Die Schrauben abwechselnd anziehen

F Serrer alternativement chaque côté

NL Afwisselend aan de linker- en de rechterkant aandraaien

I Alternare il serraggio delle viti

E Apretar alternativamente

PT Aperte alternadamente

S Dra åt växelvis

FIN Kierrä vuorotellen

EST Pinguldage vaheldumisi

LAT Pielvelciet pamīšus

LIT Užsukinėkite pakaitomis

PL Śruby dokręcaj naprzemiennie

RU Затягивайте попеременно

CZ Pokręťta bagažníka dokręcaj dokręcaj naprzemiennie.

SK Doťahujte striedavo

SLO Privijajte izmenično.

HR Naizmjenično zategnite

HU Egymástól függetlenül szorítandó

GR Σφίγγετε εναλλάξ

TR Dönüşümlü sıkın

中文 交替拧紧

한국어 번갈아 가며 조이십시오.

日本語 交互に締め付けてください。

ไทย ชั้นโน้แบบสลับ

6



480R/754



480

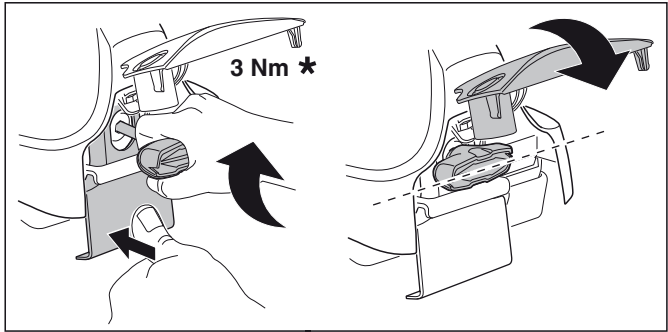
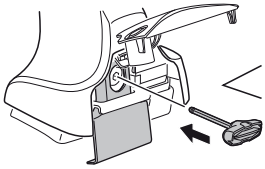

3 Nm *

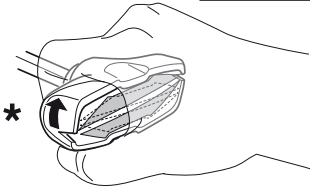

*

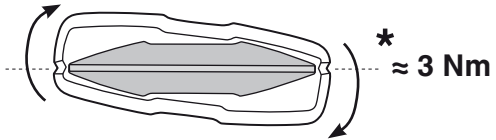

* ≈ 3 Nm



750

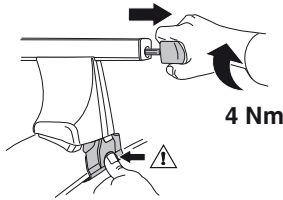

4 Nm

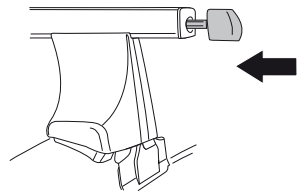

i



1



2

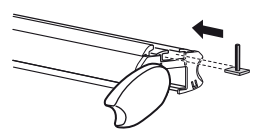

i

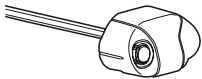

1

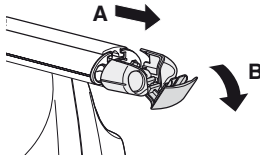

2

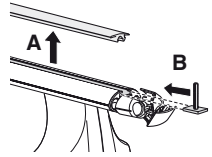

i



1

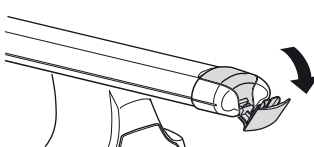

2

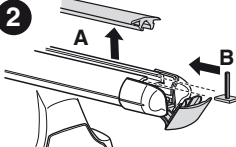



THULE
SWEDEN
**ONE
KEY
SYSTEM**



		(x4)
		(x6)
		(x8)
NA		(x10)
EUR		(x12)
ASIA		(x12)



WW ▶ Thule Sweden AB, Box 69, 330 33 Hillerstorp, SWEDEN
NA ▶ Thule Inc., 42 Silvermine Road, Seymour, Connecticut 06483, USA

info@thule.com
customer.service@thule.com

www.thule.com