

Kit 1198

KIA Rio (Mk I), 4-dr Sedan, 00-05 / *01-05

KIA Rio (Mk I), 5-dr Hatchback, 00-05

KIA Rio Cinco, 5-dr Wagon, 02-05, 06-10

*North America

480R
754

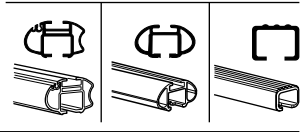
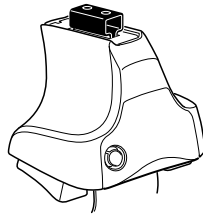

480

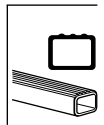
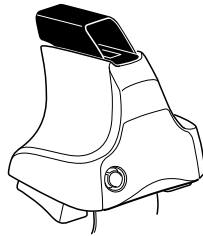

750

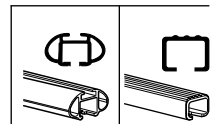
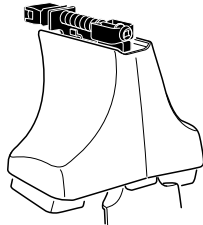

Kit



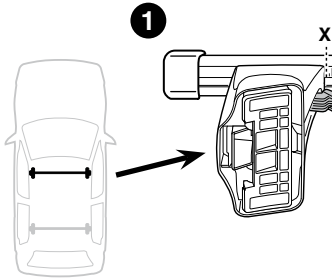

	X
KIA Rio (Mk I), 4-dr Sedan, 00-05 / *01-05	29,5
KIA Rio (Mk I), 5-dr Hatchback, 00-05	29
KIA Rio Cinco, 5-dr Wagon, 02-05, 06-10	29

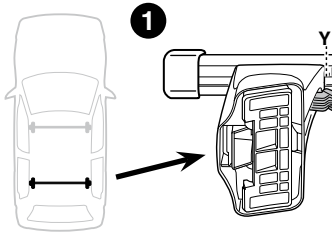

	Y
KIA Rio (Mk I), 4-dr Sedan, 00-05 / *01-05	26
KIA Rio (Mk I), 5-dr Hatchback, 00-05	26
KIA Rio Cinco, 5-dr Wagon, 02-05, 06-10	26

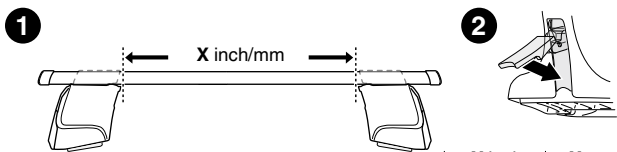
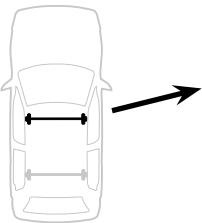
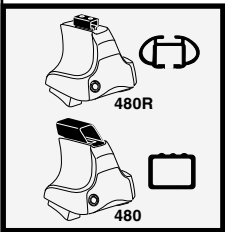

	X inch	X mm
KIA Rio (Mk I), 4-dr Sedan, 00-05 / *01-05	37 1/4"	946 mm
KIA Rio (Mk I), 5-dr Hatchback, 00-05	37"	941 mm
KIA Rio Cinco, 5-dr Wagon, 02-05, 06-10	37"	941 mm

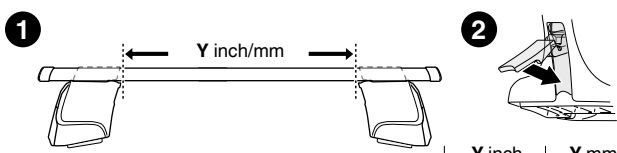
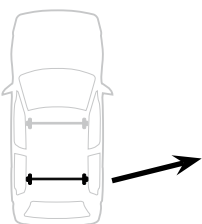

	Y inch	Y mm
KIA Rio (Mk I), 4-dr Sedan, 00-05 / *01-05	35 7/8"	911 mm
KIA Rio (Mk I), 5-dr Hatchback, 00-05	35 7/8"	911 mm
KIA Rio Cinco, 5-dr Wagon, 02-05, 06-10	35 7/8"	911 mm

4

KIA Rio (Mk I), 4-dr Sedan, 00-05 / *01-05
KIA Rio (Mk I), 5-dr Hatchback, 00-05
KIA Rio Cinco, 5-dr Wagon, 02-05, 06-10

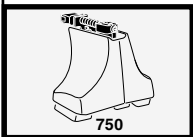
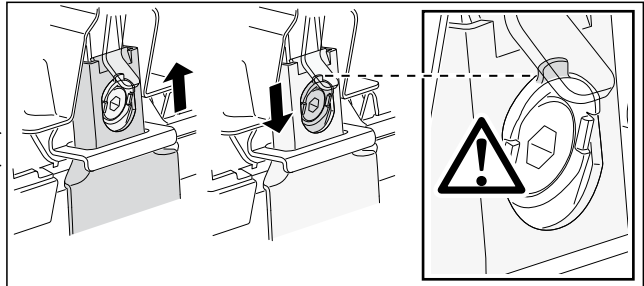
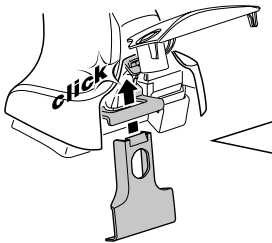
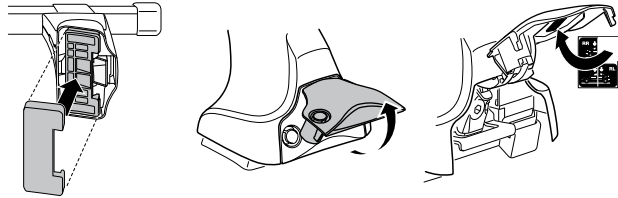
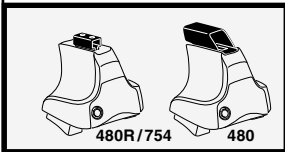
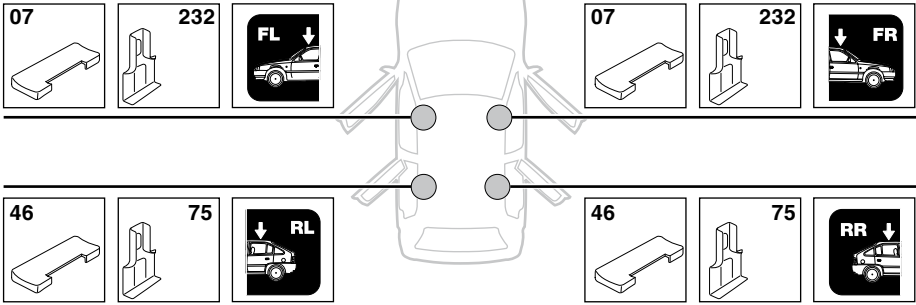

5



	X mm	Y mm	X inch	Y inch
KIA Rio (Mk I), 4-dr Sedan, 00-05 / *01-05	200 mm	615 mm	7 7/8"	24 1/4"
KIA Rio (Mk I), 5-dr Hatchback, 00-05	295 mm	700 mm	11 5/8"	27 1/2"
KIA Rio Cinco, 5-dr Wagon, 02-05, 06-10	295 mm	700 mm	11 5/8"	27 1/2"

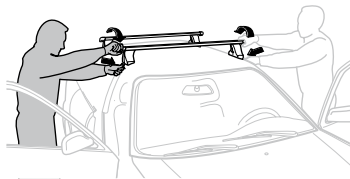
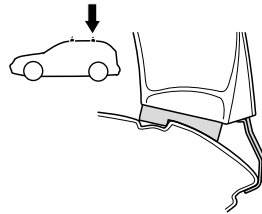
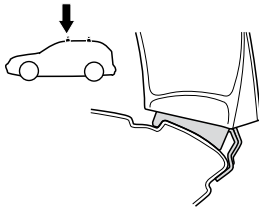
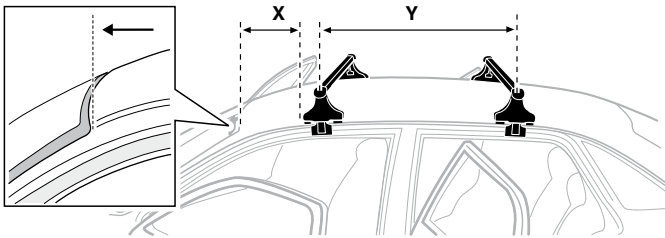

GB/US Tighten alternately

D Die Schrauben abwechselnd anziehen

F Serrer alternativement chaque côté

NL Afwisselend aan de linker- en de rechterkant aandraaien

I Alternare il serraggio delle viti

E Serrare alternativamente

PT Aperte alternadamente

S Dra åt växelvis

FIN Kierrä vuorotellen

EST Pinguldage vaheldumisi

LAT Pielieciet pamišus

LIT Užsukinėkite pakaitomis

PL Śruby dokręcaj naprzemiennie

RU Затягивайте попеременно

CZ Pokręťta bagażníka dokręcaj dokręcaj naprzemiennie.

SK Doťahujte striedavo

SLO Privijajte izmenično.

HR Naizmjenično zategnite

HU Egymástól függetlenül szorítandó

GR Σφίγγετε εναλλάξ

TR Dönüşümlü sıkın

中文 交替拧紧

한국어 번갈아 가며 조이십시오.

日本語 交互に締め付けてください。

ไทย ชั้้นโน้บแบบสลับ

6



480R/754



480

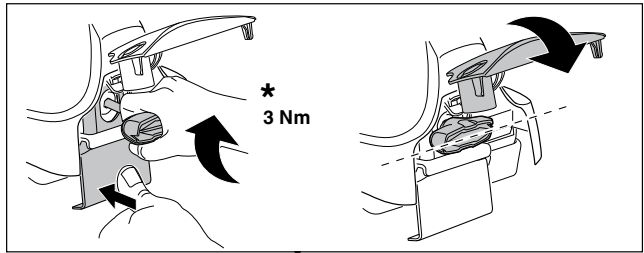

*
3 Nm



*



*
≈ 3 Nm

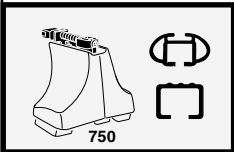

750

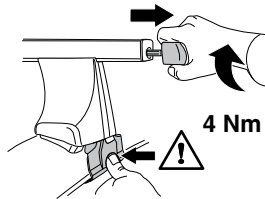

4 Nm

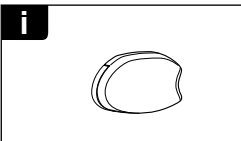
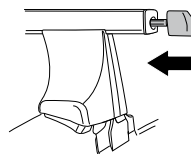

i

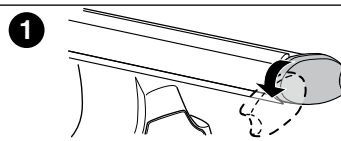

1

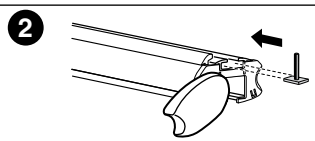

2

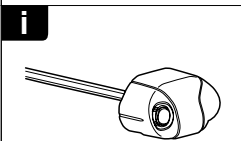

i

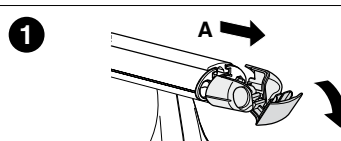

1

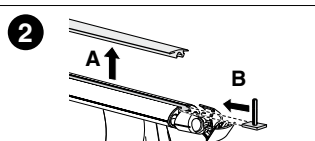

2

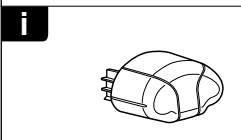

i

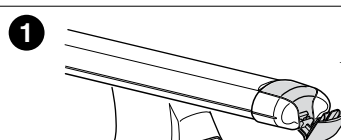

1

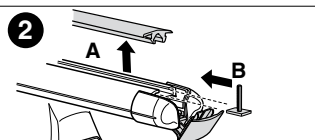

2



THULE
SWEDEN
**ONE
KEY
SYSTEM**



		(x4)
544		(x4)
596		(x6)
588		(x8)
NA 510		(x10)
EUR		(x10)
ASIA 452		(x12)



WW ▶ Thule Sweden AB, Box 69, 330 33 Hillerstorp, SWEDEN
NA ▶ Thule Inc., 42 Silvermine Road, Seymour, Connecticut 06483, USA

info@thule.com
customer.service@thule.com

www.thule.com

503-1198-02