

# Kit 1189

KIA Sephia, 4-dr Sedan, 93-97

480R  
754

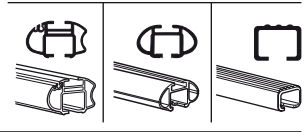

480

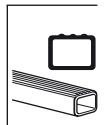

750

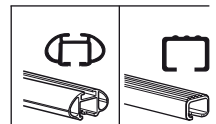
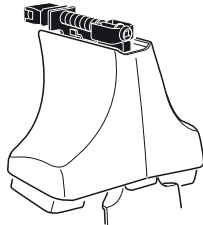

x2	x2	x2	x2	x2
x2	x2	x2	x2	x2
x2	x2	x2	x2	x2
x4	x4	x4	x4	x4

**Kit**



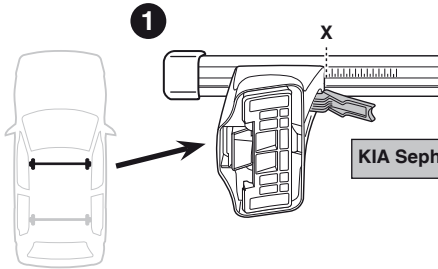

<b>KIA Sephia, 4-dr Sedan, 93-97</b>	<b>X</b>
	<b>27</b>

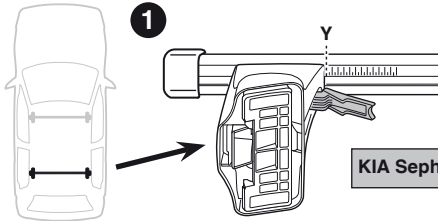

<b>KIA Sephia, 4-dr Sedan, 93-97</b>	<b>Y</b>
	<b>25,5</b>

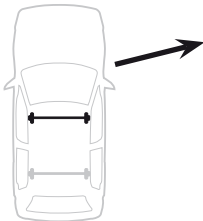

<b>KIA Sephia, 4-dr Sedan, 93-97</b>	<b>X inch</b>	<b>X mm</b>
	<b>36 1/4"</b>	<b>921 mm</b>

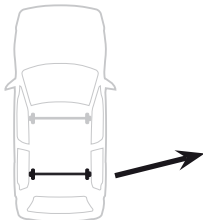

<b>KIA Sephia, 4-dr Sedan, 93-97</b>	<b>Y inch</b>	<b>Y mm</b>
	<b>35 5/8"</b>	<b>906 mm</b>



# 4

KIA Sephia, 4-dr Sedan, 93-97

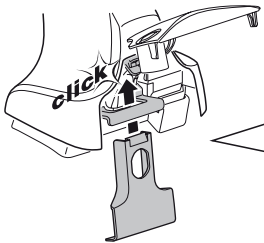
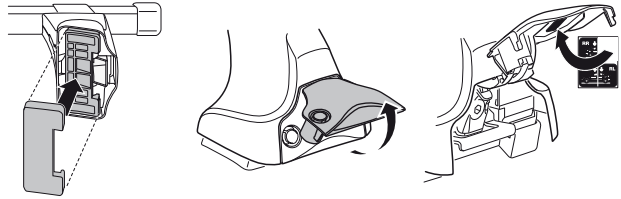
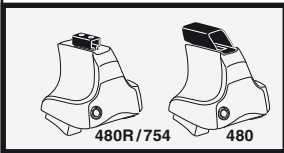
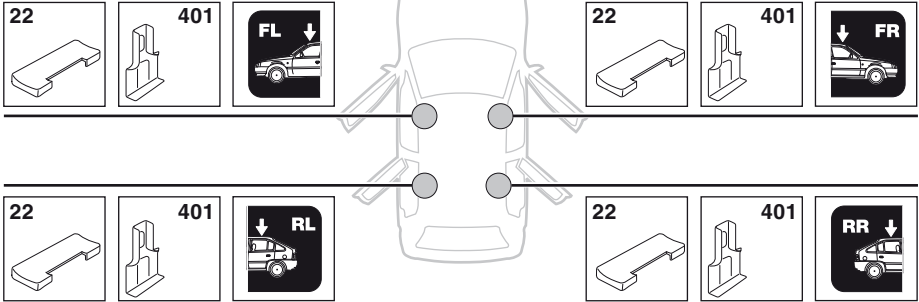

5



	X mm	Y mm	X inch	Y inch
KIA Sephia, 4-dr Sedan, 93-97	180 mm	650 mm	7 1/8"	25 5/8"

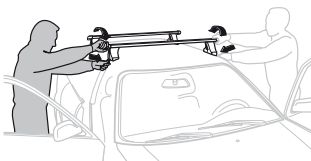
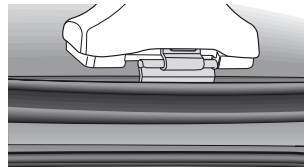
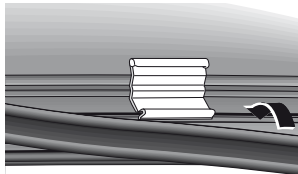
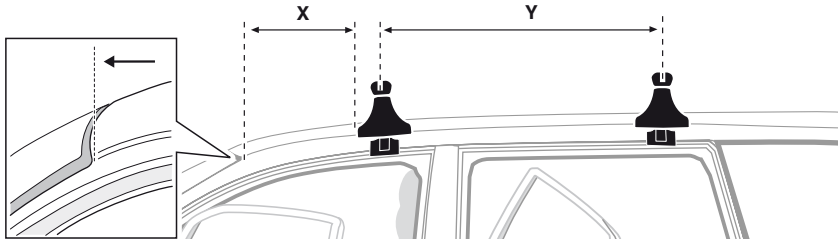

- GB/US** Tighten alternately  
**D** Die Schrauben abwechselnd anziehen  
**F** Serrer alternativement chaque côté  
**NL** Afwisselend aan de linker- en de rechterkant aandraaien  
**I** Alternare il serraggio delle viti  
**E** Apretar alternativamente  
**PT** Aperte alternadamente  
**S** Dra åt växelvis  
**FIN** Kierrä vuorotellen  
**EST** Pinguldage vaheldumisi  
**LAT** Pielieciet pamīšus  
**LIT** Užsukinėkite pakaitomis  
**PL** Śruby dokręcaj naprzemiennie  
**RU** Затягивайте попеременно

- CZ** Pokręťla bagażnika dokręcaj dokręcaj naprzemiennie.  
**SK** Dofahujte striedavo  
**SLO** Privijajte izmenično.  
**HR** Naizmjenično zategnite  
**HU** Egymástól függetlenül szorítandó  
**GR** Σφιγγεται εναλλάξ  
**TR** Dönüşümlü sıkın  
**中文** 交替拧紧  
**한국어** 번갈아 가며 조이십시오.  
**日本語** 交互に締め付けてください。  
**ไทย** ชั้้นในแบบสลับ

6



480R/754



480

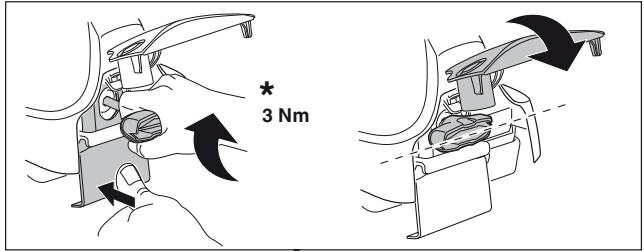
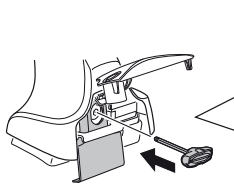

\*  
3 Nm

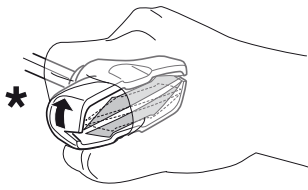

\*

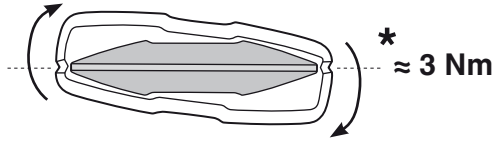

\*  
≈ 3 Nm

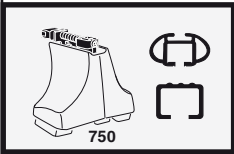
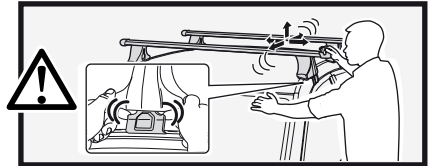

750

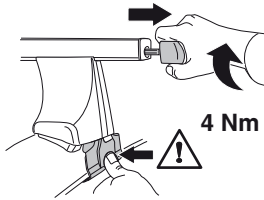

4 Nm

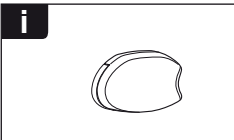
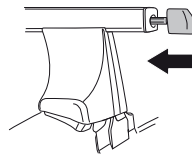

i

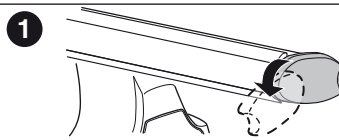

1

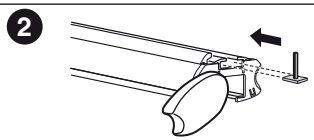

2

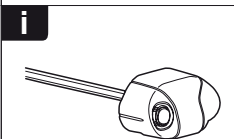

i

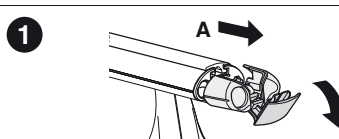

1

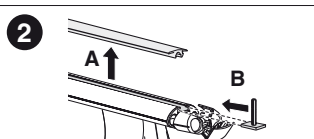

2

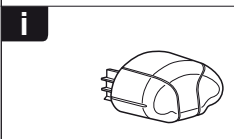

i

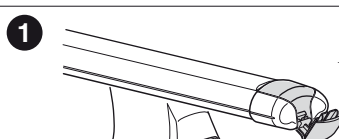

1

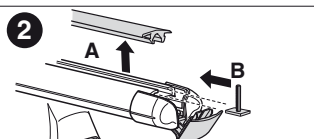

2

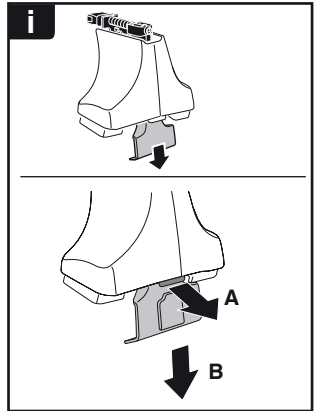

**THULE**  
SWEDEN  
**ONE  
KEY  
SYSTEM**



		(x4)
		(x6)
		(x8)
NA		(x10)
EUR		(x12)
ASIA		(x12)



WW ▶ Thule Sweden AB, Box 69, 330 33 Hillerstorp, SWEDEN  
NA ▶ Thule Inc., 42 Silvermine Road, Seymour, Connecticut 06483, USA

info@thule.com  
customer.service@thule.com

www.thule.com