

Kit 1112

HONDA Accord, 4-dr Sedan, 98-00 (JPN)

HONDA Torneo, 4-dr Sedan, 98-02

480R
754

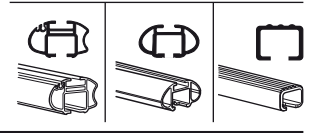
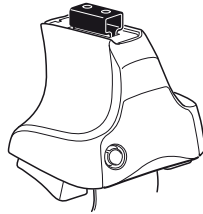

480

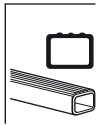
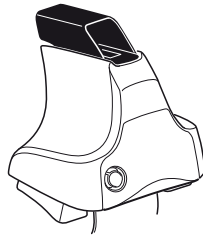

750

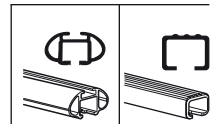
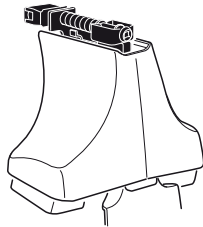

x2 x2 x2 x4	x2	x2 x2 x4 x4	x2 x2	x2

213 x2
 214 x2
 15 x4
 x1

Kit



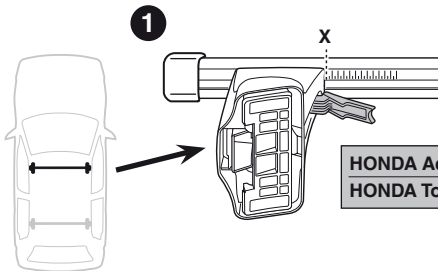

	X
HONDA Accord, 4-dr Sedan, 98-00 (JPN)	27
HONDA Torneo, 4-dr Sedan, 98-02	27

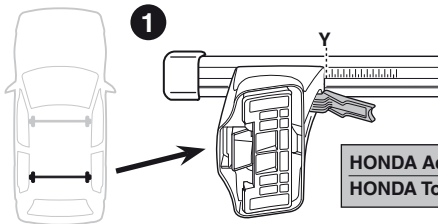

	Y
HONDA Accord, 4-dr Sedan, 98-00 (JPN)	25
HONDA Torneo, 4-dr Sedan, 98-02	25

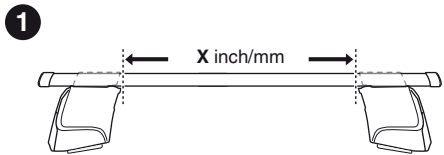
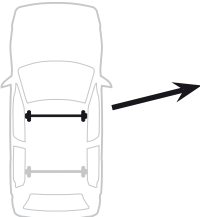
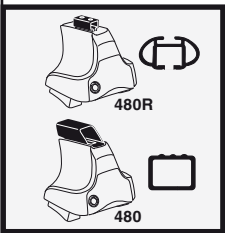

	X inch	X mm
HONDA Accord, 4-dr Sedan, 98-00 (JPN)	36 1/4"	921 mm
HONDA Torneo, 4-dr Sedan, 98-02	36 1/4"	921 mm

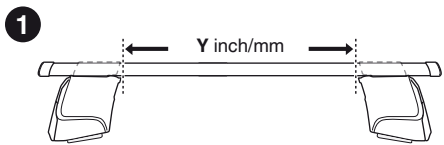
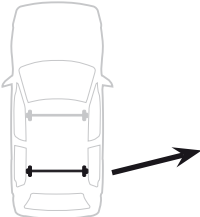

	Y inch	Y mm
HONDA Accord, 4-dr Sedan, 98-00 (JPN)	35 1/2"	901 mm
HONDA Torneo, 4-dr Sedan, 98-02	35 1/2"	901 mm

4

HONDA Accord, 4-dr Sedan, 98-00 (JPN)
 HONDA Torneo, 4-dr Sedan, 98-02

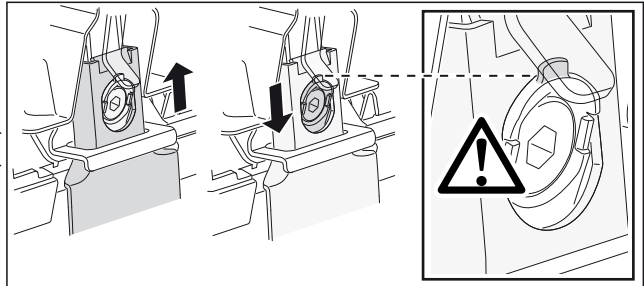
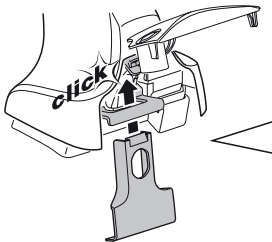
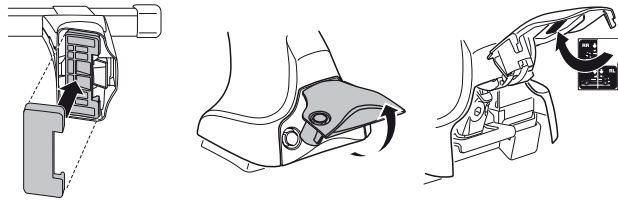
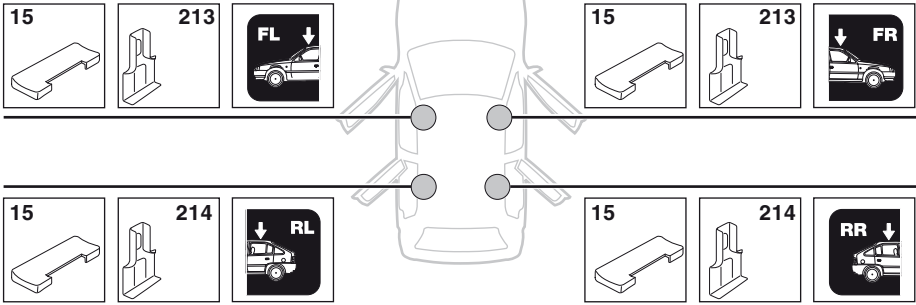

5



	X mm	Y mm	X inch	Y inch
HONDA Accord, 4-dr Sedan, 98-00 (JPN)	240 mm	660 mm	9 1/2"	26"
HONDA Torneo, 4-dr Sedan, 98-02	240 mm	660 mm	9 1/2"	26"

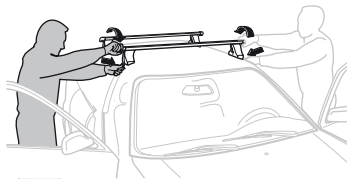
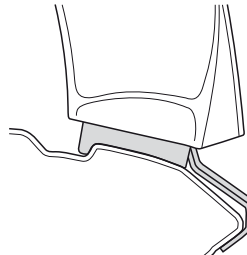
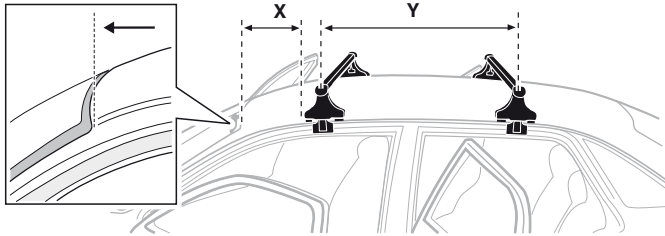

GB/US Tighten alternately

D Die Schrauben abwechselnd anziehen

F Serrer alternativement chaque côté

NL Afwisselend aan de linker- en de rechterkant aandraaien

I Alternare il serraggio delle viti

E Serrare alternativamente

PT Aperte alternadamente

S Dra åt växelvis

FIN Kierrä vuorotellen

EST Pinguldage vaheldumisi

LAT Pielvelciēt pamīšus

LIT Užsukinėkite pakaitomis

PL Śruby dokręcaj naprzemiennie

RU Затягивайте попеременно

CZ Pokręťta bagožníka dokręcaj dokręcaj naprzemiennie.

SK Doťahujte striedavo

SLO Privijajte izmenično.

HR Naizmjenično zategnite

HU Egymástól függetlenül szorítandó

GR Σφίγγετε εναλλάξ

TR Dönüşümlü sıkın

中文 交替拧紧

한국어 번갈아 가며 조이십시오.

日本語 交互に締め付けてください。

ไทย ชั้้นโน้บแบบสลับ

6



480R/754



480

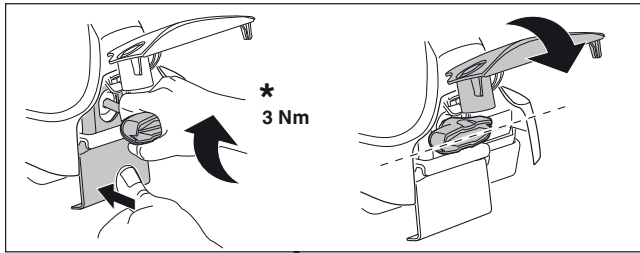
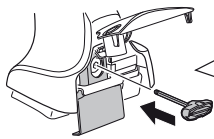

*
3 Nm

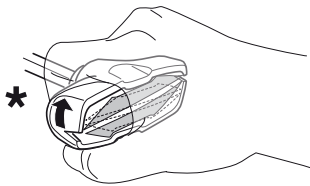

*

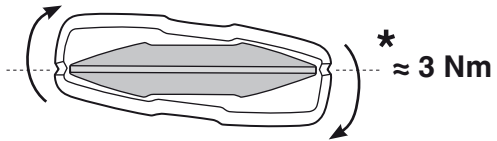

*
≈ 3 Nm

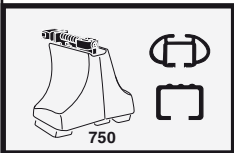
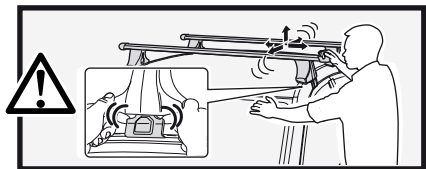

750

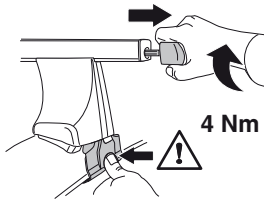

4 Nm

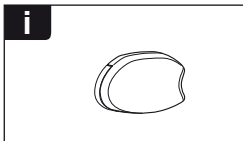
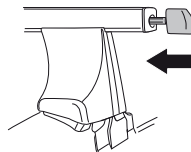

i

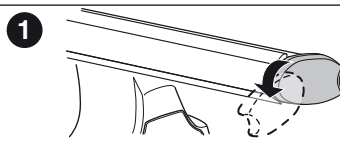

1

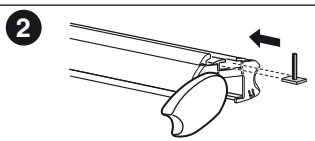

2

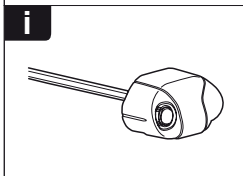

i

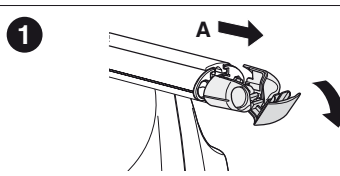

1

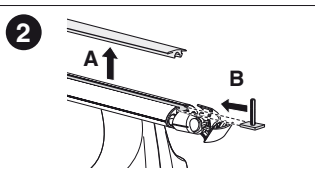

2

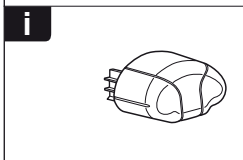

i

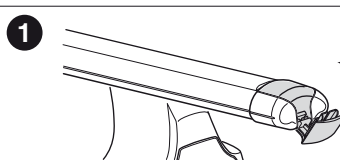

1

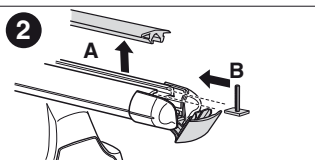

2



THULE
SWEDEN
**ONE
KEY
SYSTEM**



- 544 (x4)
- 596 (x6)
- 588 (x8)
- NA 510 (x10)
- EUR 452 (x12)
- ASIA



WW ▶ Thule Sweden AB, Box 69, 330 33 Hillerstorp, SWEDEN
NA ▶ Thule Inc., 42 Silvermine Road, Seymour, Connecticut 06483, USA

info@thule.com
customer.service@thule.com

www.thule.com