

Kit 1073

PEUGEOT 306, 4-dr Sedan, 95-00

480R
754

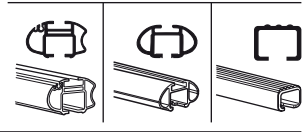
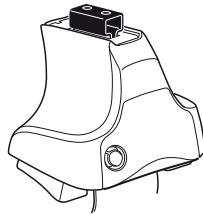

480

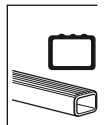
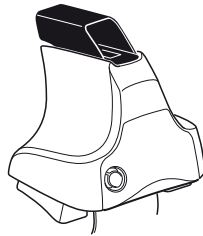

750

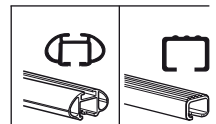
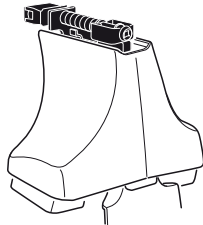

Kit



3

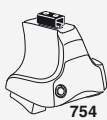

754

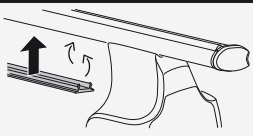
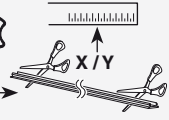

750



1

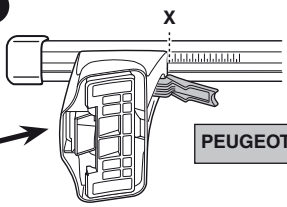

2

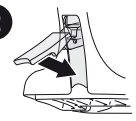

PEUGEOT 306, 4-dr Sedan, 95-00

X
23,5

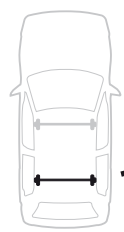

1

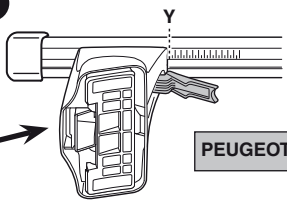

2



PEUGEOT 306, 4-dr Sedan, 95-00

Y
20



480R



480

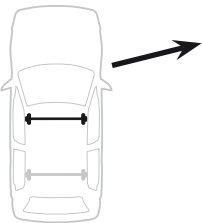

1

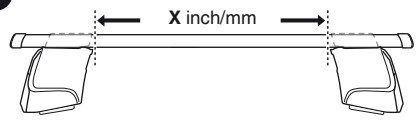

2



PEUGEOT 306, 4-dr Sedan, 95-00

X inch	X mm
34 7/8"	886 mm

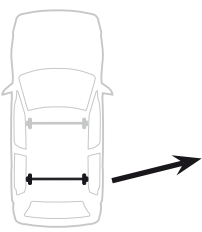

1

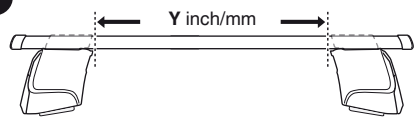

2



PEUGEOT 306, 4-dr Sedan, 95-00

Y inch	Y mm
33 1/2"	851 mm

4

PEUGEOT 306, 4-dr Sedan, 95-00

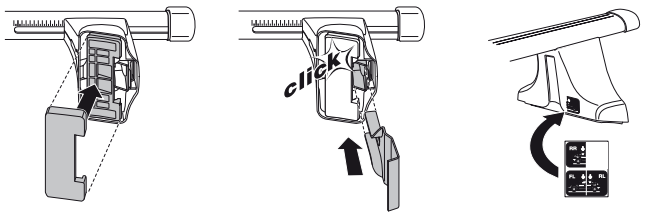
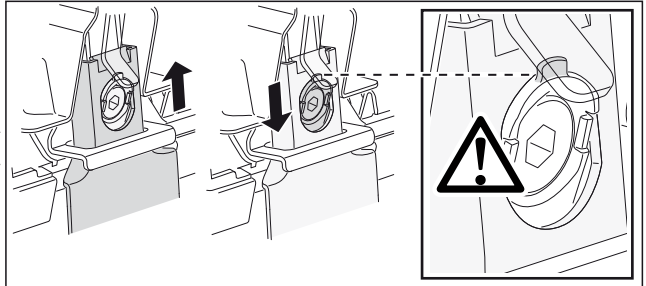
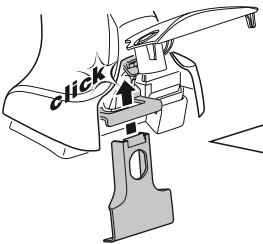
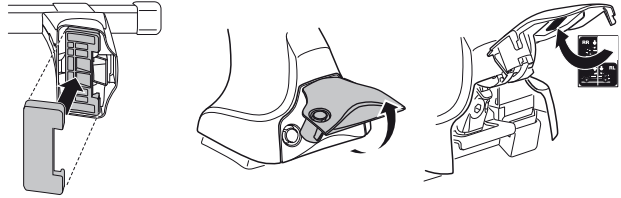
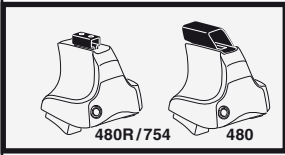
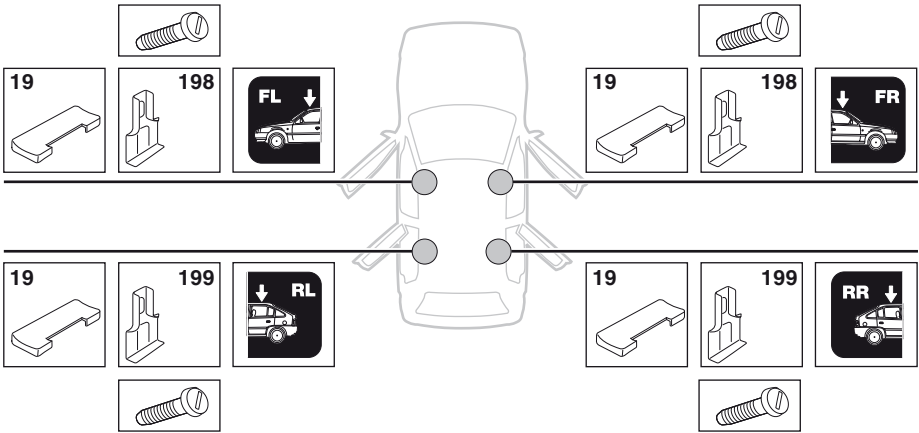

5

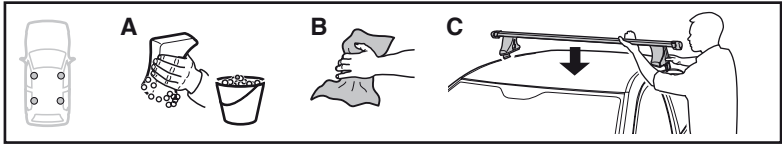

	X mm	Y mm	X inch	Y inch
PEUGEOT 306, 4-dr Sedan, 95-00	190 mm	700 mm	7 1/2"	27 1/2"

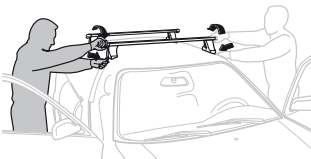
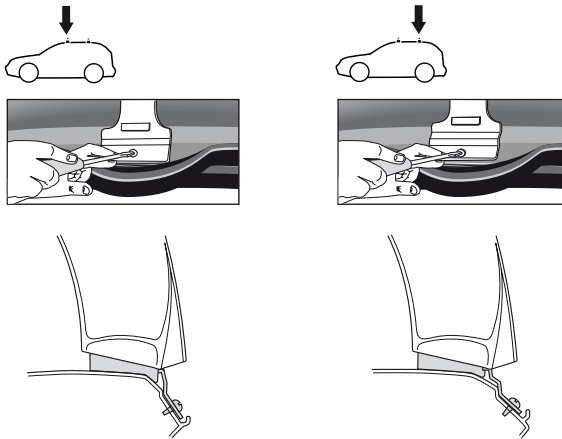
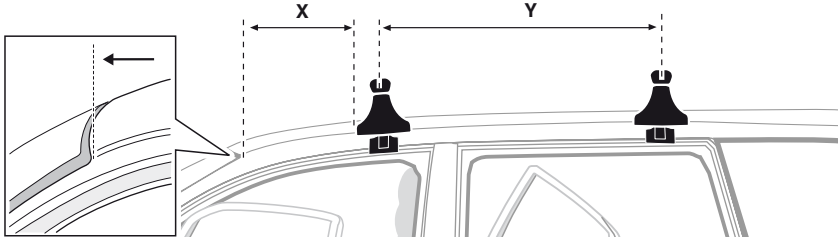

- GB/US** Tighten alternately
- D** Die Schrauben abwechselnd anziehen
- F** Serrer alternativement chaque côté
- NL** Afwisselend aan de linker- en de rechterkant aandraaien
- I** Alternare il serraggio delle viti
- E** Apretar alternativamente
- PT** Aperte alternadamente
- S** Dra åt växelvis
- FIN** Kierrä vuorotellen
- EST** Pinguldage vaheldumisi
- LAT** Pievelciēt pamišus
- LIT** Užsukinėkite pakaitomis
- PL** Śruby dokręcaj naprzemiennie
- RU** Затягивайте попеременно
- CZ** Pokręťta багаžníka dokręcaj dokręcaj naprzemiennie.
- SK** Dofahujte striedavo
- SLO** Privijajte izmenično.
- HR** Naizmjenično zategnite
- HU** Egymástól függetlenül szorítandó
- GR** Σφίγγετε εναλλάξ
- TR** Dönüşümlü sıkın
- 中文** 交替拧紧
- 한국어** 번갈아 가며 조이십시오.
- 日本語** 交互に締め付けてください。
- ไทย** ชับในแบบสลับ

6



480R/754



480

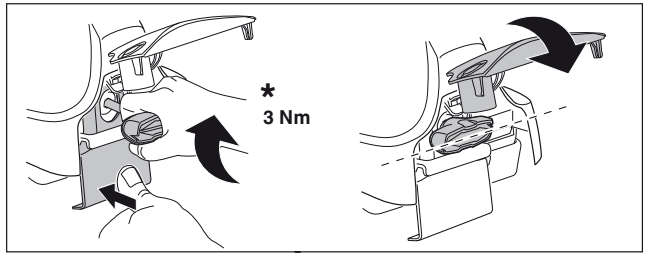
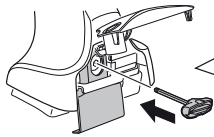

*
3 Nm

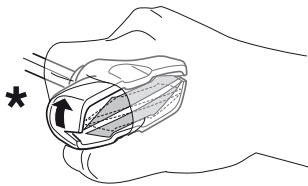

*

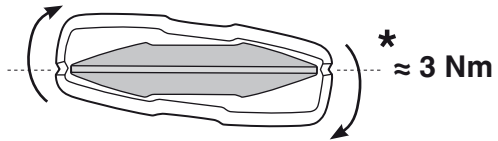

*
≈ 3 Nm

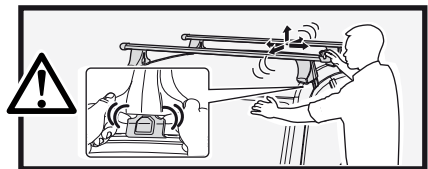

750

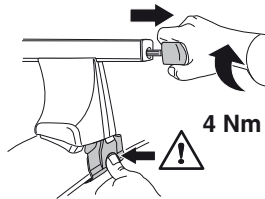

4 Nm

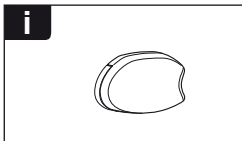
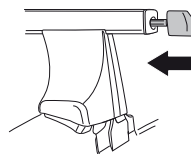

i

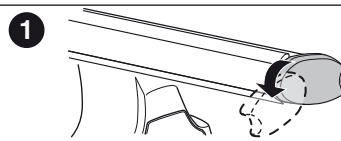

1

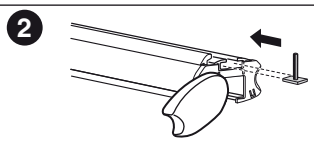

2

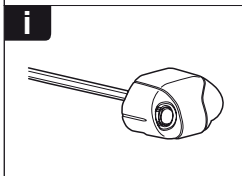

i

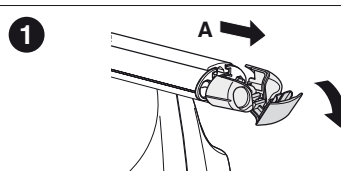

1

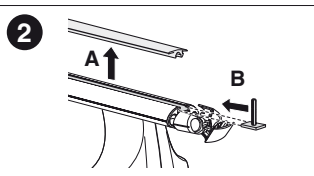

2

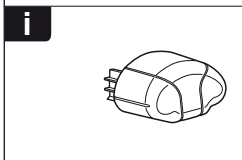

i

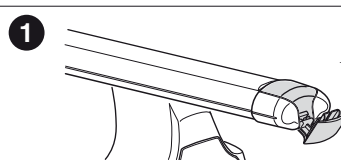

1

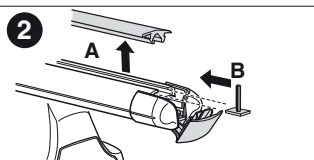

2

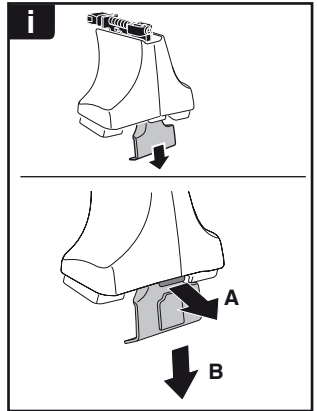
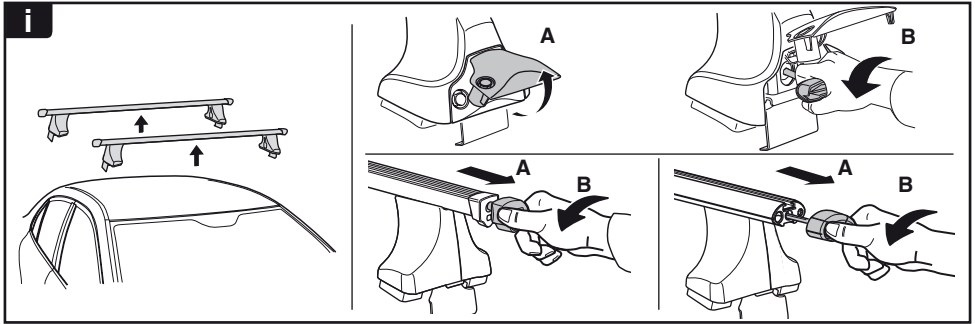

THULE
SWEDEN
**ONE
KEY
SYSTEM**



- 544 (x4)
- 596 (x6)
- 588 (x8)
- NA 510 (x10)
- EUR 452 (x12)
- ASIA



WW ▶ Thule Sweden AB, Box 69, 330 33 Hillerstorp, SWEDEN
NA ▶ Thule Inc., 42 Silvermine Road, Seymour, Connecticut 06483, USA

info@thule.com
customer.service@thule.com

www.thule.com