

Kit 1018

HONDA Accord, 4-dr Sedan, 93-98 (EUR)

ROVER 600-serie, 4-dr Sedan, 93-99

480R
754

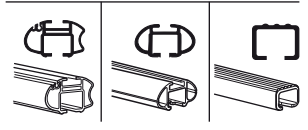
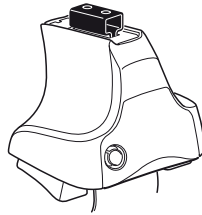

480

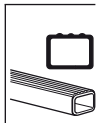
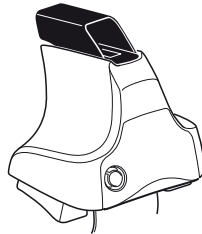

750

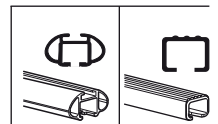
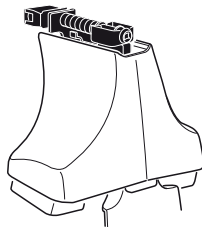

Kit



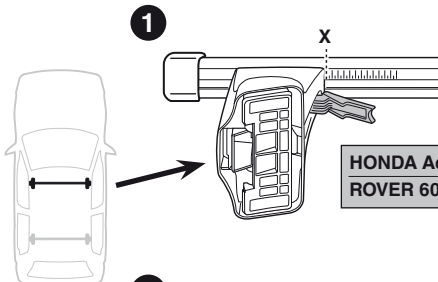
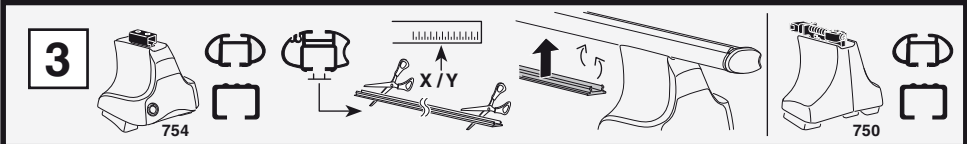

	X
HONDA Accord, 4-dr Sedan, 93-98 (EUR)	29
ROVER 600-serie, 4-dr Sedan, 93-99	29

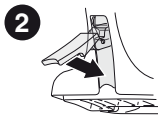
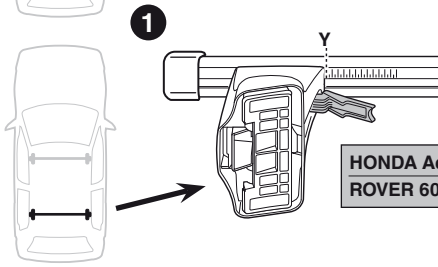

	Y
HONDA Accord, 4-dr Sedan, 93-98 (EUR)	28
ROVER 600-serie, 4-dr Sedan, 93-99	28

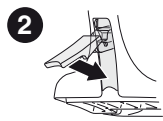
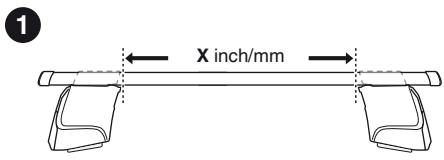
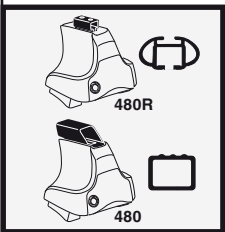

	X inch	X mm
HONDA Accord, 4-dr Sedan, 93-98 (EUR)	37"	941 mm
ROVER 600-serie, 4-dr Sedan, 93-99	37"	941 mm

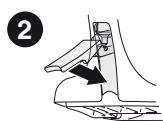
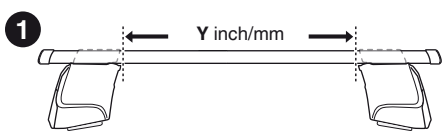

	Y inch	Y mm
HONDA Accord, 4-dr Sedan, 93-98 (EUR)	36 5/8"	931 mm
ROVER 600-serie, 4-dr Sedan, 93-99	36 5/8"	931 mm

4

HONDA Accord, 4-dr Sedan, 93-98 (EUR)

ROVER 600-serie, 4-dr Sedan, 93-99

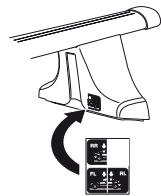
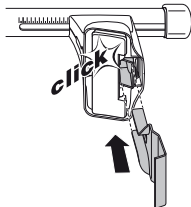
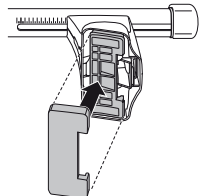
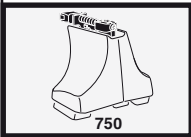
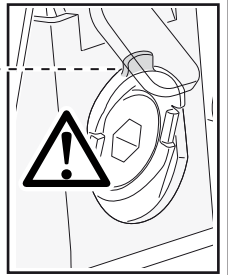
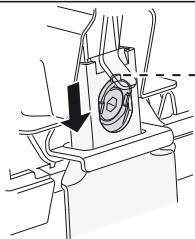
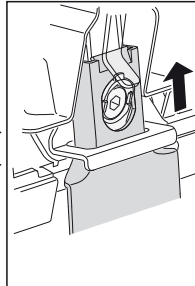
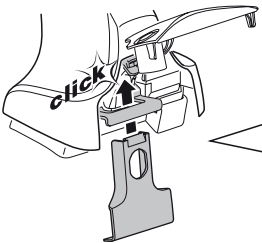
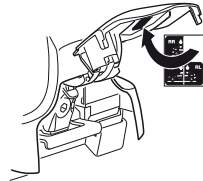
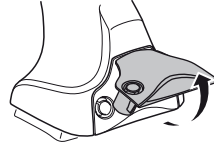
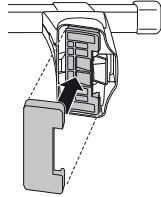
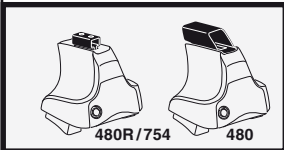
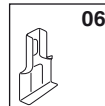
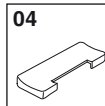
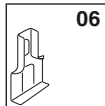
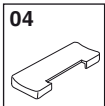
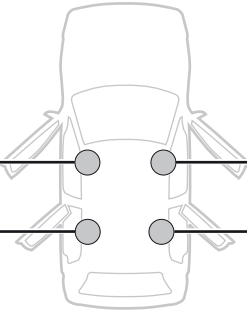
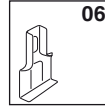
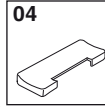
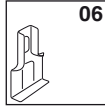
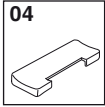

5



	X mm	Y mm	X inch	Y inch
HONDA Accord, 4-dr Sedan, 93-98 (EUR)	230 mm	700 mm	9"	27 1/2"
ROVER 600-serie, 4-dr Sedan, 93-99	230 mm	700 mm	9"	27 1/2"

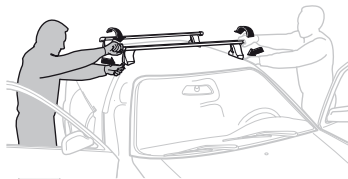
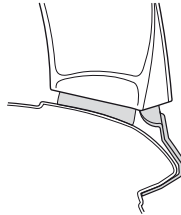
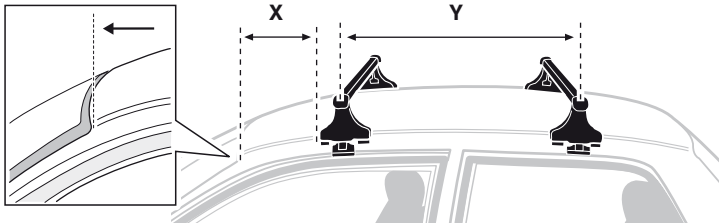

GB/US Tighten alternately

D Die Schrauben abwechselnd anziehen

F Serrer alternativement chaque côté

NL Afwisselend aan de linker- en de rechterkant aandraaien

I Alternare il serraggio delle viti

E Serrare alternativamente

PT Aperte alternadamente

S Dra åt växelvis

FIN Kierrä vuorotellen

EST Pinguldage vaheldumisi

LAT Pielieciet pamišus

LIT Užsukinėkite pakaitomis

PL Śruby dokręcaj naprzemiennie

RU Затягивайте попеременно

CZ Pokręťta bagažníka dokręcaj dokręcaj naprzemiennie.

SK Doťahujte striedavo

SLO Privijajte izmenično.

HR Naizmjenično zategnite

HU Egymástól függetlenül szorítandó

GR Σφίγγετε εναλλάξ

TR Dönüşümlü sıkın

中文 交替拧紧

한국어 번갈아 가며 조이십시오.

日本語 交互に締め付けてください。

ไทย ชั้้นโน้บแบบสลับ

6



480R/754



480



*
3 Nm



*



*
≈ 3 Nm

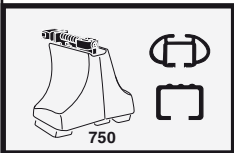
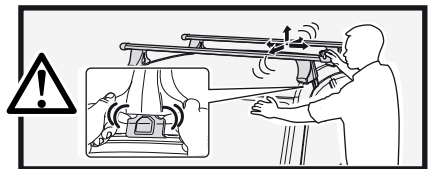

750

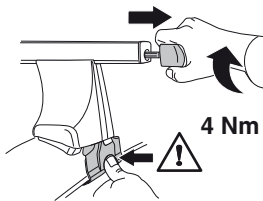

4 Nm

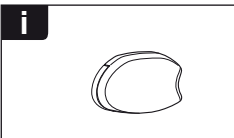
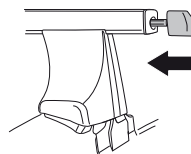

i

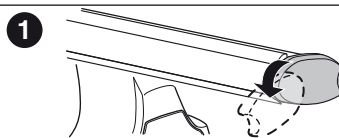

1

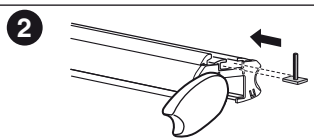

2

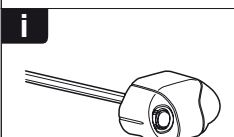

i

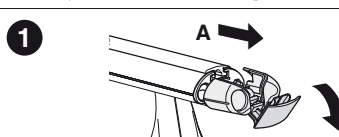

1

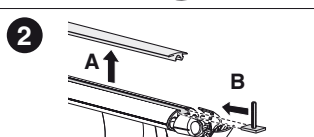

2

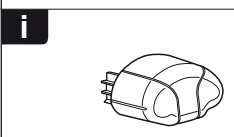

i

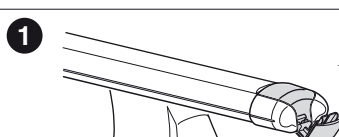

1

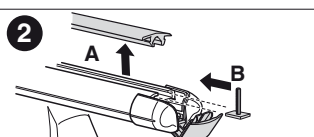

2

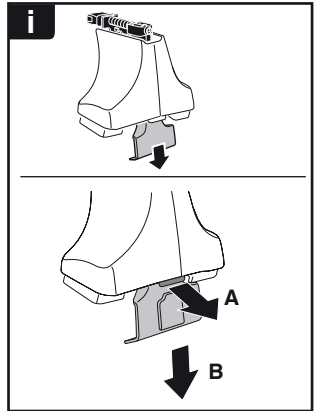

THULE
SWEDEN
**ONE
KEY
SYSTEM**



		(x4)
		(x6)
		(x8)
NA		(x10)
EUR		(x12)
ASIA		(x12)



WW ▶ Thule Sweden AB, Box 69, 330 33 Hillerstorp, SWEDEN
NA ▶ Thule Inc., 42 Silvermine Road, Seymour, Connecticut 06483, USA

info@thule.com
customer.service@thule.com

www.thule.com